HP 87130A Attenuator/Switch Driver

Operating and Service
Manual

HP part number: 87130-92024
Printed in USA
October 1998

Edition A.0.0

Notice

The information contained in this document is subject to change without notice.

Hewlett-Packard makes no warranty of any kind with regard to this material, including, but not limited to, the implied warranties of merchantability and fitness for a particular purpose. Hewlett-Packard shall not be liable for errors contained herein or for incidental or consequential damages in connection with the furnishing, performance, or use of this material.

Hewlett-Packard assumes no responsibility for the use or reliability of its software on equipment that is not furnished by Hewlett-Packard.

This document contains proprietary information which is protected by copyright. All rights are reserved. No part of this document may be photocopied, reproduced, or translated to another language without prior written consent of Hewlett-Packard Company.

Restricted Rights Legend

Use, duplication, or disclosure by the U.S. Government is subject to restrictions as set forth in subparagraph (c)(1)(ii) of the Rights in Technical Data and Computer Software clause at DFARS 252.227-7013 for DOD agencies, and subparagraphs (c)(1) and (c)(2) of the Commercial Computer Software Restricted Rights clause at FAR 52.227-19 for other agencies.

Hewlett-Packard Company
Santa Rosa Systems Division
1400 Fountaingrove Parkway
Santa Rosa, CA 95403-1799, U.S.A.

NOTE

A serial number label is attached to the rear panel of each instrument. The first six entries are the same for all identical modules; they only change when a change in the electrical or physical functionality is made. The remaining digits are assigned sequentially and are different for each instrument.

This manual applies directly to instruments with the following serial numbers and above:

US37349000

© Copyright Hewlett-Packard Company 1994, 1998

Warranty

Certification

Hewlett-Packard Company certifies that this product met its published specifications at the time of shipment from the factory. Hewlett-Packard further certifies that its calibration measurements are traceable to the United States National Institute of Standards and Technology (NIST, formerly NBS), to the extent allowed by the Institute's calibration facility, and to the calibration facilities of other International Standards Organization members.

Warranty

This Hewlett-Packard system product is warranted against defects in materials and workmanship for a period corresponding to the individual warranty periods of its component products. Instruments are warranted for a period of one year. During the warranty period, Hewlett-Packard Company will, at its option, either repair or replace products that prove to be defective.

Warranty service for products installed by HP and certain other products designated by HP will be performed at Buyer's facility at no charge within HP service travel areas. Outside HP service travel areas, warranty service will be performed at Buyer's facility only upon HP's prior agreement and Buyer shall pay HP's round trip travel expenses. In all other areas, products must be returned to a service facility designated by HP.

For products returned to HP for warranty service, Buyer shall prepay shipping charges to HP and HP shall pay shipping charges to return the product to Buyer. However, Buyer shall pay all shipping charges, duties, and taxes for products returned to HP from another country.

HP warrants that its software and firmware designated by HP for use with an instrument will execute its programming instructions when properly installed on that instrument. HP does not warrant that the operation of the instrument, or software, or firmware will be uninterrupted or error free.

LIMITATION OF WARRANTY. The foregoing warranty shall not apply to defects resulting from improper or inadequate maintenance by Buyer, Buyer-supplied software or interfacing, unauthorized modification or misuse, operation outside of the environmental specifications for the product, or improper site preparation or maintenance.

NO OTHER WARRANTY IS EXPRESSED OR IMPLIED. HP SPECIFICALLY DISCLAIMS THE IMPLIED WARRANTIES OR MERCHANTABILITY AND FITNESS FOR A PARTICULAR PURPOSE.

EXCLUSIVE REMEDIES. THE REMEDIES PROVIDED HEREIN ARE BUYER'S SOLE AND EXCLUSIVE REMEDIES. HP SHALL NOT BE LIABLE FOR ANY DIRECT, INDIRECT, SPECIAL, INCIDENTAL, OR

CONSEQUENTIAL DAMAGES, WHETHER BASED ON CONTRACT, TORT, OR ANY OTHER LEGAL THEORY.

Assistance

Product maintenance agreements and other customer assistance agreements are available for Hewlett-Packard products.

For assistance, call your local Hewlett-Packard Sales and Service Office (refer to “Service and Support on page v.)

Service and Support

Any adjustment, maintenance, or repair of this product must be performed by qualified personnel. Contact your customer engineer through your local HP Service Center. You can find a list of HP Service Centers on the web at <http://www.hp.com/go/tmdir>.

If you do not have access to the Internet, one of these HP centers can direct you to your nearest HP representative:

United States:	Hewlett-Packard Company Test and Measurement Call Center PO Box 4026 Englewood, CO 80155-4026 (800) 452 4844 (toll-free in US)
Canada:	Hewlett-Packard Canada Ltd. 5150 Spectrum Way Mississauga, Ontario L4W 5G1 (905) 206 4725
Europe:	Hewlett-Packard European Marketing Centre Postbox 999 1180 AZ Amstelveen The Netherlands (31 20) 547 9900
Japan:	Hewlett-Packard Ltd. Measurement Assistance Center 9-1, Takakura-Cho, Hachioji-Shi Tokyo 192, Japan (81) 426 56 7832 (81) 426 56 7840 (FAX)
Latin America:	Hewlett-Packard Latin American Region Headquarters 5200 Blue Lagoon Drive, 9th Floor Miami, Florida 33126, U.S.A. (305) 267 4245, (305) 267-4220 (305) 267 4288 (FAX)
Australia/New Zealand:	Hewlett-Packard Australia Ltd. 31-41 Joseph Street Blackburn, Victoria 3130 Australia 1 800 629 485 (Australia) 0800 738 378 (New Zealand) (61 3) 9210 5489 (FAX)
Asia-Pacific:	Hewlett-Packard Asia Pacific Ltd. 17-21/F Shell Tower, Times Square 1 Matheson Street, Causeway Bay Hong Kong (852) 2599 7777 (852) 2506 9285 (FAX)

Safety and Regulatory Information

Review this product and related documentation to familiarize yourself with safety markings and instructions before you operate the instrument. This product has been designed and tested in accordance with international standards.

WARNING

The **WARNING** notice denotes a hazard. It calls attention to a procedure, practice, or the like, that, if not correctly performed or adhered to, could result in personal injury. Do not proceed beyond a **WARNING** notice until the indicated conditions are fully understood and met.

CAUTION

The **CAUTION** notice denotes a hazard. It calls attention to an operating procedure, practice, or the like, which, if not correctly performed or adhered to, could result in damage to the product or loss of important data. Do not proceed beyond a **CAUTION** notice until the indicated conditions are fully understood and met.

Instrument Markings



When you see this symbol on your instrument, you should refer to the instrument's instruction manual for important information.



This symbol indicates hazardous voltages.



This symbol indicates that the instrument requires alternating current (ac) input.



The CE mark is a registered trademark of the European Community. If it is accompanied by a year, it indicates the year the design was proven.



The CSA mark is a registered trademark of the Canadian Standards Association.



The C-Tick mark is a registered trademark of the Australian Spectrum Management Agency.

ISM1-A

This text indicates that the instrument is an Industrial Scientific and Medical Group 1 Class A product (CISPER 11, Clause 4).



This symbol indicates that the power line switch is ON.



This symbol indicates that the power line switch is OFF or in STANDBY position.



Safety Earth Ground

This is a Safety Class I product (provided with a protective earthing terminal). An uninterruptible safety earth ground must be provided from the main power source to the product input wiring terminals, power cord, or supplied power cord set. Whenever it is likely that the protection has been impaired, the product must be made inoperative and secured against any unintended operation.

Before Applying Power

Verify that the product is configured to match the available main power source as described in the input power configuration instructions in this manual. If this product is to be powered by autotransformer, make sure the common terminal is connected to the neutral (grounded) side of the ac power supply.

Compliance With German Noise Requirements

This is to declare that this instrument is in conformance with the German Regulation on Noise Declaration for Machines (Laermangabe nach der Maschinenlaermrrerordnung-3.GSGV Deutschland).

Acoustic Noise Emmision/Geraeuschemission	
LpA <70 dB	LpA <70 dB
Operator position	am Arbeitsplatz
Normal position	normaler Betrieb
per ISO 7779	nach DIN 45635 t. 19

General Safety Considerations

WARNING

- This product has been designed and tested in accordance with IEC Publication 1010, Safety Requirements for Electronic Measuring Apparatus, and has been supplied in a safe condition. The instruction documentation contains information and warnings which must be followed by the user to ensure safe operation and to maintain the product in a safe condition.
- This is a Safety Class 1 Product provided with a protective earthing ground incorporated in the power cord. The mains plug shall only be inserted in a socket outlet provided with a protective earth contact. Any interruption of the protective conductor inside or outside of the product is likely to make the product dangerous. Intentional interruption is prohibited.
- The ON/OFF switch or the detachable power cord is the instrument disconnecting device. It disconnects the mains circuits from the mains supply before other parts of the instrument. Alternately, an externally installed switch or circuit breaker, which is readily identifiable and is easily reached by the operator, may be used as a disconnecting device.
- This instrument has autoranging line voltage input. Be sure the power supply voltage is within the specified range.

WARNING

- This product is designed for use in Installation Category and Pollution Degree 2 per IEC 1010 and 664 respectively.
- Install the instrument according to the enclosure protection provided. This instrument protects against finger access to hazardous parts within the enclosure. The instrument does not protect against the ingress of water.
- If this product is not used as specified, the protection provided by the equipment could be impaired. This product must be used in a normal condition (in which all means for protection are intact) only.
- When installing the product in a cabinet, the convection into and out of the product must not be restricted. The ambient temperature (outside the cabinet) must be less than the maximum operating temperature of the product by 4° C for every 100 watts dissipated in the cabinet. If the total power dissipated in the cabinet is greater than 800 watts forced convection must be used.

Declaration of Conformity

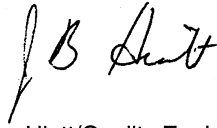
DECLARATION OF CONFORMITY	
according to ISO/IEC Guide 22 and EN 45014	
Manufacturer's Name:	Hewlett-Packard Co.
Manufacturer's Address:	Microwave Instruments Division 1400 Fountaingrove Parkway Santa Rosa, CA 95403-1799 USA
declares that the product	
Product Name:	Attenuator/Switch Driver
Model Number:	HP 87130A
Product Options:	This declaration covers all options of the above product.
conforms to the following Product specifications:	
Safety: IEC 348:1978/HD 401 S1:1981 CAN/CSA-C22.2 No. 231 (Series M-89)	
EMC: CISPR 11:1990/EN 55011:1991 Group 1, Class A IEC 801-2:1984/EN 50082-1:1992 4 kV CD, 8 kV AD IEC 801-3:1984/EN 50082-1:1992 3 V/m, 27-500 MHz IEC 801-4:1988/EN 50082-1:1992 0.5 kV Sig. Lines, 1 kV Power Lines	
Supplementary Information:	
The product herewith complies with the requirements of the Low Voltage Directive 73/23/EEC and the EMC Directive 89/336/EEC and carries the CE-marking accordingly.	
Product safety qualification testing for this product was performed prior to 1 December 1993.	
Santa Rosa, California, USA 16 May 1997	 John Hiatt/Quality Engineering Manager
European Contact: Your local Hewlett-Packard Sales and Service Office or Hewlett-Packard GmbH, Department HQ-TRE, Herrenberger Strasse 130, D-71034 Böblingen, Germany (FAX +49-7031-14-3143)	

Typeface Conventions

- Italics**
 - Used to emphasize important information:
Use this software *only* with the HP xxxxxX system.
 - Used for the title of a publication:
Refer to the *HP xxxxxX System-Level User's Guide*.
 - Used to indicate a variable:
Type `LOAD BIN filename`.
- Instrument Display**
 - Used to show on-screen prompts and messages that you will see on the display of an instrument:
The HP xxxxxX will display the message `CAL1 SAVED`.
- [Keycap]**
 - Used for labeled keys on the front panel of an instrument or on a computer keyboard:
Press `[Return]`.
- {Softkey}**
 - Used for simulated keys that appear on an instrument display:
Press `{Prior Menu}`.
- User Entry**
 - Used to indicate text that you will enter using the computer keyboard; text shown in this typeface must be typed *exactly* as printed:
Type `LOAD PARMFILE`
 - Used for examples of programming code:
`#endif // ifndef NO_CLASS`
- Path Name**
 - Used for a subdirectory name or file path:
Edit the file `usr/local/bin/sample.txt`
- Computer Display**
 - Used to show messages, prompts, and window labels that appear on a computer monitor:
The **Edit Parameters** window will appear on the screen.
 - Used for menus, lists, dialog boxes, and button boxes on a computer monitor from which you make selections using the mouse or keyboard:
Double-click **EXIT** to quit the program.

Contents

1. Introducing the HP 87130A Attenuator/Switch Driver

Features of the Attenuator/Switch Driver	1-2
<i>Figure 1-1. HP 87130A Block Diagram</i>	1-2
Drive Pulse and Sensing Delay	1-2
Compatible Switches and Attenuators	1-3
<i>Table 1-1. Compatible Hewlett-Packard Switches</i>	1-3
<i>Table 1-2. Compatible Hewlett-Packard Attenuators</i>	1-4
Front Panel Features	1-4
<i>Figure 1-2. HP 87130A Front Panel Features</i>	1-4
Unpacking Your Instrument	1-5
<i>Table 1-3. HP 87130A Package Contents</i>	1-5
Determining Your Module Serial Number	1-5
Environmental Limitations	1-5
<i>Figure 1-3. Packaging Materials for the HP 87130A Switch Driver</i>	1-6
Before Installing the HP 87130A Switch Driver	1-7
<i>Figure 1-4. Static-Safe Work Station</i>	1-7
Reducing ESD Damage	1-7
<i>Table 1-4. Static-Safe ESD Accessories</i>	1-8
Returning Your Instrument for Service	1-9

2. Installing the HP 87130A Attenuator/Switch Driver

Getting Started	2-2
Initial Inspection	2-2
Preparing for Use	2-2
HP-IB Addressing	2-4
<i>Figure 2-1. HP 87130A HP-IB Address Switch (Default 9 shown)</i>	2-4
Connecting Switch Drivers to Switches and Attenuators	2-5
Driver Boards	2-5
Using the Internal Driver	2-5
<i>Figure 2-2. Typical Operating Setup Using Internal Driver</i>	2-5
Using External Drivers	2-6
<i>Figure 2-3. Typical Operating Setup Using External Drivers</i>	2-6
Wiring Channel Connectors	2-7
<i>Figure 2-4. Typical Single Switch Channel Connector</i>	2-7
Connecting Multiple Driver Cards	2-8
<i>Figure 2-5. Daisy Chain of Driver Cards in Single Enclosure</i>	2-8
<i>Figure 2-6. Daisy Chain of Driver Cards in Different Enclosures</i>	2-8
Connecting Attenuators	2-9
<i>Figure 2-7. Typical Attenuator Cables Connected to an HP 84940A</i>	2-9
Optimizing Switching Speed	2-10

Table 2-1. Relay Drive Sequence	2-10
Driver Card Address	2-11
Figure 2-8. Eight Driver Card Addresses	2-11
Driver Cable and Switch Cable Length Limitations	2-11
Pin Functions for 36-Pin I/O Data Cable	2-13
Table 2-2. Standard 36-Pin (Male) SCSI II Type Connector Pin Functions	2-13
Pin Functions for 68-pin Driver Output Connector	2-14
Table 2-3. 68-Pin (Female) SCSI II Type Connector Pin Functions ...	2-14

3. Specifications

Performance Specifications	3-2
Table 3-1. HP 87130A Electrical Specifications	3-2
Table 3-2. HP 87130A Environmental Specifications	3-3

4. Verification

Performance Tests	4-2
Conditions	4-2
Recommended Test Equipment	4-2
Table 4-1. Recommended Test Equipment for HP 87130A	4-2
Pulse Parameters Test	4-3
Table 4-2. Specification	4-3
Hardware Limits	4-3
Figure 4-1. Pulse Parameters Test Setup	4-4

5. Local Operation

6. Remote Operation

Programming	6-2
Standard Commands	6-2
Language	6-2
Programming Syntax	6-3
Talking to the Switch Driver	6-3
Programming Conventions	6-3
Addressing the Switch Driver	6-4
Program Message Syntax	6-4
Commands	6-5
Program Header Options	6-6
Program Data	6-6
Program Message Terminator	6-7
Query Command	6-7
Programming the Switch Driver	6-9
Initialization	6-9
Setting Up the Switch Driver	6-9
Receiving Information from the Switch Driver	6-9
String Variables	6-11
Instrument Status	6-11
Common Commands Reference	6-12

Table 6-1. IEEE 488.2 Common Commands	6-12
*CLS (Clear Status)	6-13
*ESE (Event Status Enable)	6-14
Table 6-2. Event Status Enable Register Bit Definitions	6-14
*ESR? (Event Status Register Query)	6-15
Table 6-3. Event Status Register Bit Definitions	6-15
*IDN (Identification Number)	6-16
*OPC (Operation Complete)	6-17
*RST (Reset)	6-18
*SRE (Request Enable)	6-19
Table 6-4. Service Request Enable Register	6-19
*STB (Status Byte)	6-20
Table 6-5. Status Byte Bit Definitions	6-20
*TST? (Test)	6-21
*WAI	6-22
Hierarchy	6-23
Table 6-6. Command Tree	6-23
SCPI Command Reference	6-26
Channel Lists	6-26
SCPI Commands	6-26
:ADD	6-27
:AUTOselect	6-28
:CATalog?	6-29
:CLOSe	6-30
:CYCLes?	6-33
:DEFine	6-34
:DELay	6-36
:DELete	6-37
:DRIVE	6-39
:EERom	6-41
:ERRor?	6-42
:FREE.	6-45
:GROUP	6-46
:INITialize	6-47
:LABel[?]	6-48
MEMory	6-49
:NAME	6-50
:OPEN	6-51
:PATH	6-54
:PFail	6-55
:REMove	6-56
ROUte	6-57
:SAVE	6-58
STATus	6-59
SYSTem	6-60
TRIGger	6-61

:VALue	6-62
:VERify	6-63
:VERsion?	6-65
:WIDTh	6-66
Example Programs	6-67
Example Speed Calculation	6-73
<i>Table 6-7. Relay Drive Sequence</i>	6-73
<i>Figure 6-1. Timing Chart</i>	6-76

7. Replaceable Parts

Accessory Boards and Cables	7-3
<i>Table 7-1. Accessories</i>	7-3
Firmware Revisions	7-3
<i>Table 7-2. Replaceable Parts - HP 87130A Chassis Assembly (1)</i> .	7-4
<i>Figure 7-1. HP 87130A Chassis Assembly (1)</i>	7-5
<i>Table 7-3. Replaceable Parts - HP Chassis Assembly (2)</i>	7-6
<i>Figure 7-2. HP 87130A Chassis Assembly (2)</i>	7-7
<i>Table 7-4. Replaceable Parts - HP 87130A Cable Assembly</i>	7-8
<i>Figure 7-3. HP 87130A Cable Assembly</i>	7-9

8. Troubleshooting

Troubleshooting	8-2
Tests	8-2
Conditions	8-2
<i>Figure 8-1. HP 87130A DC Schematic</i>	8-3
Recommended Test Equipment	8-4
<i>Table 8-1. Recommended Test Equipment for HP 87130A</i>	8-4
Fuse and Power Supply Tests	8-5
<i>Figure 8-2. Power Supply Test Points</i>	8-5
Pulse Parameters Test	8-6
<i>Table 8-2. Specification</i>	8-6
Hardware Limits	8-6
<i>Figure 8-3. Pulse Parameters Test Setup</i>	8-7
Procedure for Setting Up the EPROM	8-10

1

Introducing the HP 87130A Attenuator/Switch Driver

Overview

In this chapter you will find:

- Function, features, and capabilities of the HP 87130A switch driver
- How to unpack and check your instrument
- How to set up a static-free workstation
- How to contact Hewlett-Packard for service

Features of the Attenuator/Switch Driver

The HP 87130A attenuator/switch driver is an HP-IB compatible instrument designed to drive electromechanical switches and step attenuators.

- The standard instrument has a single internal driver board capable of driving up to 31 SPDT switches, or combinations of SPDT and multithrow switches.
- The HP 87130A attenuator/switch driver may be externally connected to a maximum of seven HP 84940A driver boards and can control and sense switching for up to 248 switches.

The block diagram is shown below. Refer to Figure 8-1 in Chapter 8, “Troubleshooting” for a detailed DC Schematic.

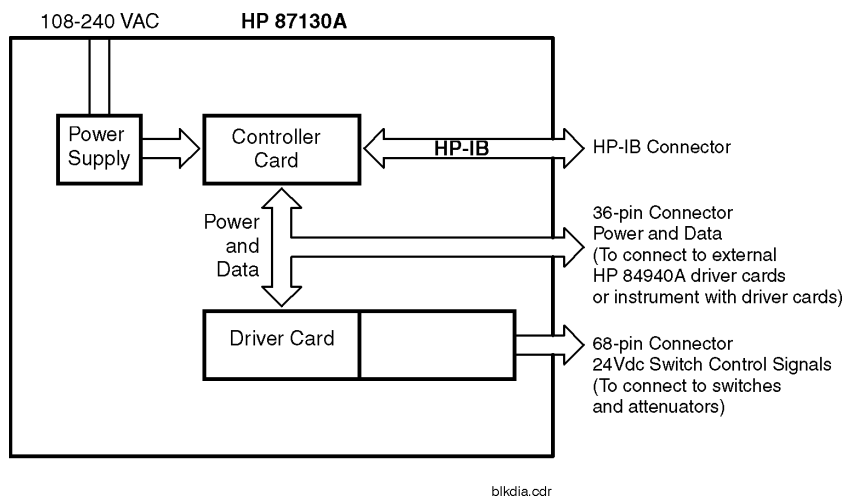

Figure 1-1 HP 87130A Block Diagram

Drive Pulse and Sensing Delay

- The HP 87130A can deliver 200 mA, 24 Vdc current pulses to 31 individual switch sections and up to a total of 248 switch sections by the addition of external HP 84940A driver boards (or driver boards inside externally connected equipment such as switch matrixes). These low impedance pulses can be adjusted for pulse width in order to optimize switching speed.
- The switch driver can verify switching operation when used with switches that can sense switch position (such as the HP 8762C switches). This kind of switch requires additional time to be added to allow sense lines to settle. The recommended delay for the HP 8762C

switches is 20 ms. The sensing delay can be adjusted to conform to switch characteristics.

- Pulse width and sensing delay can be set from 0.005 to 1.275 seconds per switching operation in 0.005 second increments. The pulse width default setting is 30 ms. The sensing delay default setting is 20 ms.
- The power supply allows the switch driver four switching operations (200 mA per throw) at the same time. This means that at the default setting, seven groups of four switches and one group of three switches will each take 50 ms to switch and verify. This results in a default switching speed of 0.4 seconds for 31 relays with sensing enabled. Refer to the “Speed Calculation Example” at the end of Chapter 6, “Remote Operation.”

Compatible Switches and Attenuators

The HP 87130A is designed to drive the Hewlett-Packard switches and attenuators shown in the tables below. If you are using switches or attenuators made by another company, check their switching characteristic against those specified in Chapter 3, “Specifications”.

Table 1-1 *Compatible Hewlett-Packard Switches*

Model Number	Description	Model Number	Description
HP 33311A,B,C,D	Terminated SPDT	HP 8765A,B,C,F (Opt 024)	Unterminated SPDT*
HP 33312A,B,C	Terminated transfer	HP 8766K	SP3T
HP 33313A,B,C	5 port switch	HP 8767K	SP4T
HP 33314A,B,C,D (Opt 024)	Unterminated SPDT*	HP 8768K	SP5T
HP 33363K	SP3T	HP 8769K	SP6T
HP 33364K	SP4T	HP 87104A,B,C	SP4T*
HP 33365K	SP5T	HP 87106 A,B,C	SP6T*
HP 33366K	SP6T	HP 87204A,B,C	SP4T
HP 8762A,B,C,F	Terminated SPDT	HP 87206A,B,C	SP6T
HP 8763A,B,C,F	Terminated transfer	HP 87606B	Matrix switch
HP 8764A,B,C,F	5 port switch	* No position verification	

Table 1-2 Compatible Hewlett-Packard Attenuators

Model Number	Description	Model Number	Description
HP 33320G,H	11 dB, 1 dB steps	HP 8494G,H	11 dB, 1 dB steps
HP 33321G,H,K	70 dB, 10 dB steps	HP 8495G,H,K	70 dB, 10 dB steps
HP 33322G,H	110 dB, 10 dB steps	HP 8496G,H	110 dB, 10 dB steps
HP 33323K	90 dB, 10 dB steps	HP 8497K	90 dB, 10 dB steps
HP 33324K,L	11 dB, 1 dB steps	HP 84904K,L	11 dB, 1 dB steps
HP 33326K,L	90 dB, 10 dB steps	HP 84906K,L	90 dB, 10 dB steps
HP 33327K,L	70 dB, 10 dB steps	HP 84907K,L	70 dB, 10 dB steps

Front Panel Features

The front panel LEDs indicate the status of the HP 87130A attenuator/switch driver. The front-panel LEDs should turn on and off while the switch driver is performing the self-test (for example, at turn-on).

If the ERROR LED lights at any time other than during self test, an error condition exists in the switch matrix. The switch driver ERROR light indicates it is ready to report one or more error codes. The error code(s) may be viewed in using the :ERROR? command from a controller. Refer to Chapter 6, “Remote Operation” for more information.

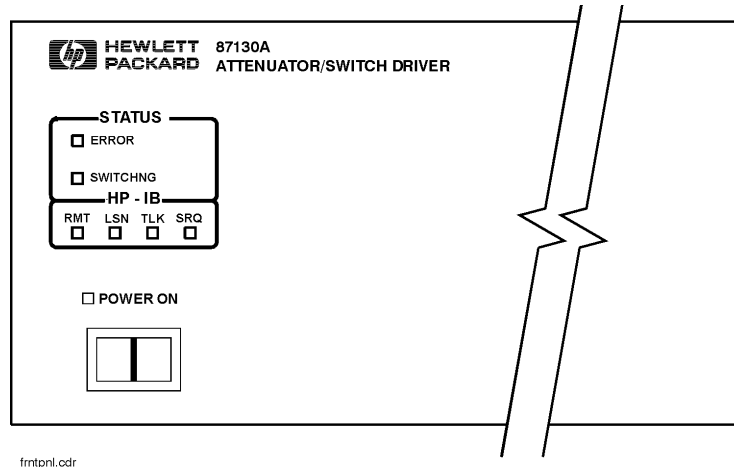

Figure 1-2 HP 87130A Front Panel Features

The user may remotely set the SRQ (service request) state to take place under certain conditions, (for example: completion of an operation or if an error condition occurs). The SRQ LED will only be lit during self test, when it is turned on and off to test the LED.

The other LEDs, RMT (remote), LSN (listen), TLK (talk), and SWITCHING indicate the normal functioning of the switch driver and do not indicate an error condition.

Unpacking Your Instrument

Unpack and inspect the shipping container and its contents thoroughly to ensure that nothing was damaged during shipment. If the shipping container or cushioning material is damaged, the contents should be checked both mechanically and electrically.

WARNING

To avoid hazardous electrical shock, do not perform electrical tests when there are signs of shipping damage to any portion of the outer enclosure (covers, panels, connectors.)

Table 1-3 HP 87130A Package Contents

Description	Quantity	HP Part Number
Switch driver	1	HP 87130A
Operating and Service Manual	1	87130-92024
Cable, 68-pin to 68-pin SCSI II, 6 ft.	1	70611-60004

- If the shipping container is damaged, or the cushioning material shows signs of stress, notify the carrier as well as Hewlett-Packard. Keep the shipping material for the carrier's inspection. Refer to Figure 1-3.
- If the contents are damaged or defective, contact your nearest Hewlett-Packard Sales and Service Office. Refer to "Service and Support" on page v. Hewlett-Packard will arrange for repair or replacement of the damaged or defective equipment. Always refer to your instrument by its full model number and serial number.

Determining Your Module Serial Number

When a module is manufactured by Hewlett-Packard, it is given a unique serial number. This serial number is attached to a label on the front frame or front panel of the module. The first six entries are the same for all identical modules; they only change when a change in the electrical or physical functionality is made. The remaining entries change sequentially and are different for each module.

Environmental Limitations

The instrument should be stored in a clean, dry environment. The following environmental limitations apply to both shipment and storage:

Temperature	- 40° C to +70° C
Humidity	< 95% relative
Altitude	< 15 300 meters (50,000 feet)

Introducing the HP 87130A Attenuator/Switch Driver
Unpacking Your Instrument

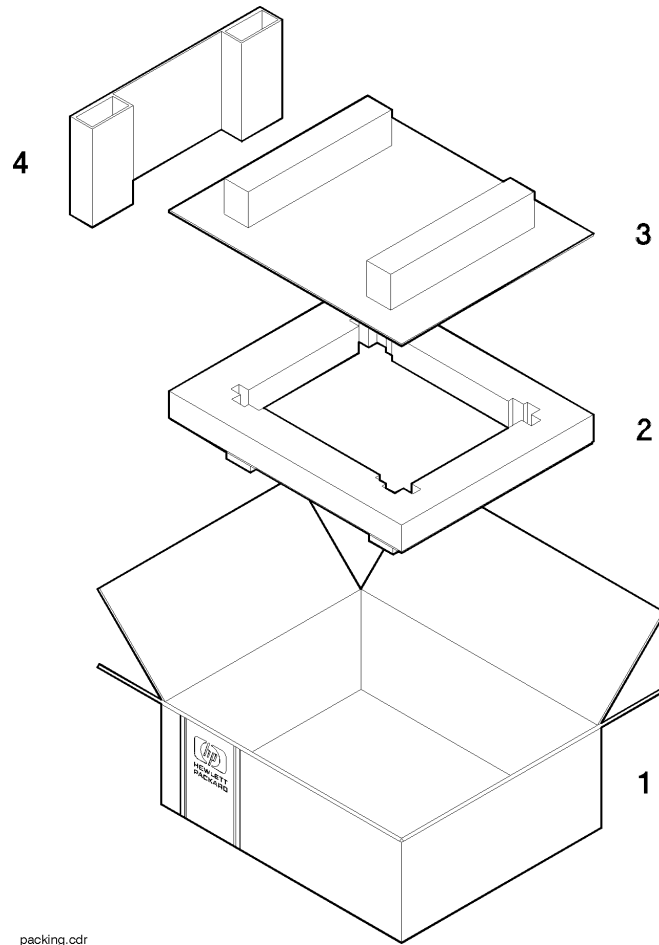

packing.cdr

Figure 1-3 *Packaging Materials for the HP 87130A Switch Driver*

Item	Quantity	HP Part Number	Description
1	1	9211-6365	Outer carton
2	1	5181-5515	Foam Insert
3			Foam insert (Part of item 2.)
4	1	5181-5535	Spacer

Before Installing the HP 87130A Switch Driver

Electrostatic discharge (ESD) can damage or destroy electronic components. All work performed on assemblies consisting of electronic components should be done at a static-safe workstation.

An example of a static-safe work station is shown below using two types of ESD protection:

- conductive table mat and wrist strap combination, and
- conductive floor mat and heel strap combination

These methods may be used together or separately. A list of static-safe accessories and their part numbers is given on the following page.

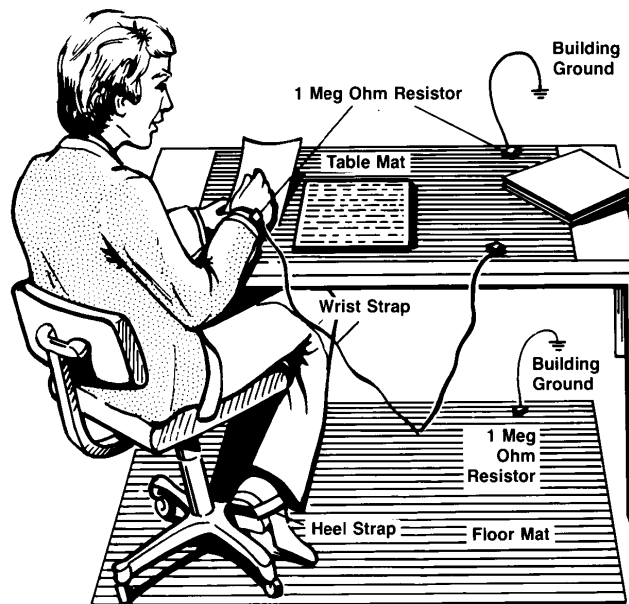

Figure 1-4 Static-Safe Work Station

Reducing ESD Damage

To help reduce the amount of ESD damage that occurs during installation, testing, or servicing instruments use the following guidelines:

- Be sure that all instruments are properly earth-grounded to prevent buildup of static charge.
- Personnel should be grounded with a resistor-isolated wrist strap before touching the center pin of any connector and before removing any assembly from the instrument.

Before Installing the HP 87130A Switch Driver

- Before connecting any coaxial cable to an instrument connector for the first time each day, *momentarily* ground the center and outer conductors of the cable.
- Handle all PC board assemblies and electronic components only at static-safe work stations.
- Store or transport PC board assemblies and electronic components in static-shielding containers.
- PC board assembly edge-connector contacts may be cleaned by using a lintfree cloth with a solution of 80% electronics-grade isopropyl alcohol and 20% deionized water. This procedure should be performed at a static-safe work station.

Table 1-4 Static-Safe ESD Accessories

HP Part Number	Description
9300-0797	Set includes: 3M static control mat 0.6 m x 1.2 m (2 ft x 4 ft) and 4.6 m (15 ft) ground wire. (The wrist-strap and wrist-strap cord are not included. They must be ordered separately.)
9300-0865	Ground wire, 4.6 m (15 ft)
9300-0980	Wrist-strap cord 1.5 m (5 ft)
9300-1367	Wrist-strap, color black, stainless steel, without cord, has four adjustable links and a 7 mm post-type connection.
9300-1308	ESD heel-strap (reusable 6 to 12 months)

Order the above by calling HP DIRECT at (800) 538-8787) or through any Hewlett-Packard Sales and Service Office.

Returning Your Instrument for Service

To obtain servicing information or to order replacement parts, contact the nearest Hewlett-Packard sales and service office listed in “Service and Support” on page v.

Use the following procedure to return your instrument to Hewlett-Packard for service:

1. Fill out a service tag and attach it to the instrument. Please be as specific as possible about the nature of the problem.

CAUTION

Damage can result if the original packaging materials are not used. Packaging materials should be anti-static and should cushion the instrument on all sides.

Never use styrene pellets in any shape as packaging materials. They do not adequately cushion the instrument or prevent it from moving in the shipping container. Styrene pellets can also cause equipment damage by generating static electricity or by lodging in fan motors.

2. Place the switch driver in its original packaging materials.

If the original packaging materials are not available, you can contact a Hewlett-Packard sales and service office to obtain information on packaging materials or you may use an alternative packing material referred to as “bubble-pack”. One of the companies that makes bubble-pack is Sealed Air Corporation of Hayward, California, 94545.

3. Surround the module with at least 3 to 4 inches of its original packing material or bubble-pack to prevent it from moving in its shipping container.
4. Place the switch driver after wrapping it with packing material, in its original shipping container or a strong shipping container that is made of double-walled corrugated cardboard with 159 kg (350 lb) bursting strength.

The shipping container must be both large enough and strong enough to accommodate your module and allow at least 3 to 4 inches on all sides for packing material.

5. Seal the shipping container securely with strong nylon adhesive tape.
6. Mark the shipping container “FRAGILE, HANDLE WITH CARE” to help ensure careful handling.
7. Retain copies of all shipping papers.

Introducing the HP 87130A Attenuator/Switch Driver
Returning Your Instrument for Service

2

Installing the HP 87130A Attenuator/Switch Driver

Overview

In this chapter you will learn about:

- How to install your switch driver
- How to verify its basic functionality
- How to address your instrument
- How to connect it to a switch matrix

Getting Started

Initial Inspection

1. Unpack and inspect the shipping container and its contents thoroughly to ensure that nothing was damaged during shipment. If the shipping container or cushioning material is damaged, the contents should be checked both mechanically and electrically. A procedure for checking the electrical performance is given in Chapter 4, Verification.
 - If the shipping container is damaged, or the cushioning material shows signs of stress, notify the carrier as well as Hewlett-Packard. Keep the shipping material for the carrier's inspection. Refer to Figure 1-3.
 - If the contents are damaged or defective, contact your nearest Hewlett-Packard Sales and Service Office. Refer to "Service and Support" on page v. Hewlett-Packard will arrange for repair or replacement of the damaged or defective equipment.

Preparing for Use

2. Use the following properties of the attenuator/switch driver to plan your system configuration.

Power requirements

The HP 87130A requires a power source of 110 V to 233 V from 48 to 440 Hz. Power consumption is 110 Watts maximum. The internal power supply adjusts automatically to the input line voltage.

Power cord

In accordance with international safety standards, a three-wire power cable is provided with this instrument. When it is connected to an appropriate ac power receptacle, this cable grounds the instrument cabinet. The type of power cable plug shipped with each instrument depends on the country of destination.

Fuses

The HP 8713A is shipped with a 1A fuse (F3) installed in the +24 Vdc line. This fuse protects the integrated circuits of the internal driver board against accidental shorting of the driver board outputs.

In some of the following circumstances, it may be necessary to install a higher current fuse. However, it may be advisable to configure your system first with the 1 A fuse in place to be sure that there are no wiring errors before you substitute a 3A fuse.

If a fuse change is made, the integrated circuits of the driver board are no longer as well protected against accidental miswiring and may void the warranty of your instrument.

- If you are controlling external driver boards connected to switches that have a quiescent current draw. (The internal power supply is capable of supplying 3.5 A steady state at 24 Vdc.)

For example, if you are using seven (total) “fully loaded” driver boards with seven HP 87104A switches driven by each board, the quiescent current could be as much as 7 X 50 mA per board times seven boards, or 2.45 A. Since 2.45 A plus actuating current of 400 mA equals 2.85A, a 3 A fuse may be used.

- If additional current is being used by customer-driven front panel LEDs that are driven off of the switch drive lines or by programmable attenuators, whose four sections can be actuated simultaneously totaling 500mA (instead of 400 mA for a switch).

NOTE

Take care in the channel assignment in which the switches are wired to the driver board so that only one multiport switch is activated by each “drive line” as defined in Table 2-1.

For example, two 1X4 switches should be wired to J1 through J4 and J5 through J8. (Twice the current would occur on “drive line” 2 if the switches were wired to J3 through J6 and J7 through J10.)

Getting Started**HP-IB Addressing**

3. Use the five-bit binary address switches located on the rear panel of the instrument to change the HP-IB address.
 - *The HP 87130A has a factory preset address of 9.* There are 32 possible addresses. The switch labeled with a one is the least significant bit.
 - Addresses 0 and 31 are typically reserved for HP-IB functions and should not be used. IEEE-488.1 limits the number of addressable elements (instruments) to 16.

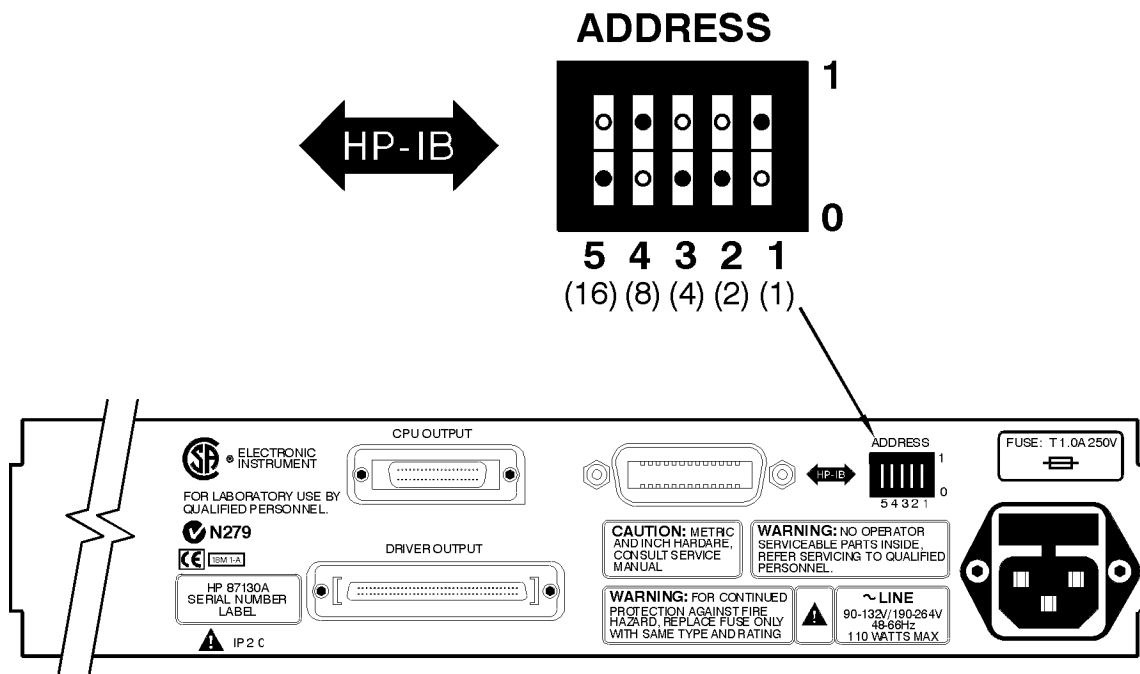

hpibaddr.cdr

Figure 2-1 HP 87130A HP-IB Address Switch (Default 9 shown)

Connecting Switch Drivers to Switches and Attenuators

Driver Boards

The standard HP 87130A attenuator/switch driver has a single internal driver board capable of driving 31 switches. The HP 87130A attenuator/switch driver may also be connected to a maximum of seven external HP 84940A driver board which can control and sense switching states for up to 217 additional switches.

The internal driver card is terminated with a 68-pin SCSI II type connector for connecting external switches. The HP 84941A distribution board should be used to connect the switch driver to switches and attenuators.

- The distribution board has 31 4-pin black output connectors numbered J1 to J31 (silkscreened on the circuit side of the PCA), in addition to 31 mating cables which allow a cable harness to be quickly assembled to connect to relays. Refer to Figure 2-4 for pin wiring that determines an OPEN or CLOSE condition on each switch.
- Each relay (switch) is referred to as a *channel* by the switch driver. Each channel has its own unique address. The switch driver begins numbering channels at 0 instead of 1. Switch one, wired to J1 on driver card 1, would have a channel address of 100.

Using the Internal Driver

1. Connect the internal driver board of the HP 87130A switch driver which is terminated with a 68-pin SCSI II type connector (Driver Output) to an HP 84941A distribution board. Use the six foot cable with two male 68-pin SCSI II type connectors that is shipped with the HP 87130A.

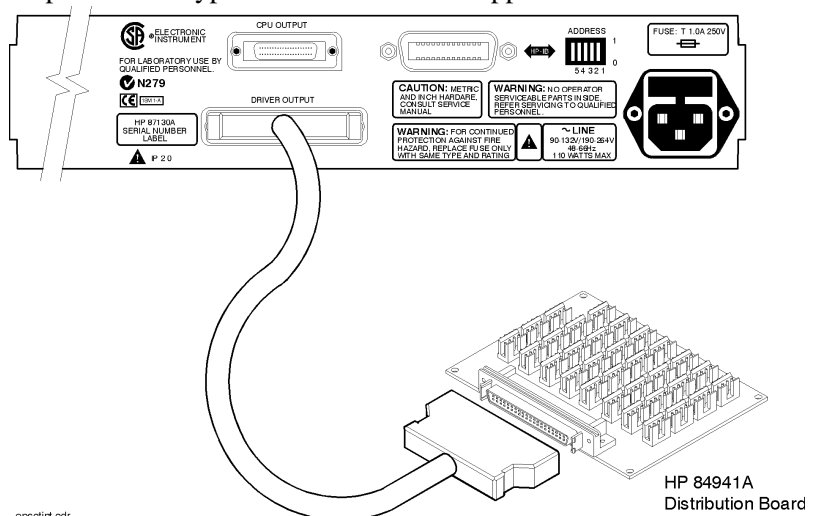

Figure 2-2 Typical Operating Setup Using Internal Driver

Using External Drivers

A standard switch driver can control up to seven external HP 84940A driver cards.

- Each driver card has 31 4-pin black output connectors numbered J1 to J31 (silkscreened on the circuit side of the PCA) which connect to relays.
- Each relay is referred to as a *channel* by the switch driver. Therefore, there are a total of 248 relays (channels) that can be driven from a single switch driver.
- Each card must have a unique address. (Refer to Figure 2-8). The internal driver card is set to card 1. On card 1, J1 to J31 correspond to channels 100 to 130 on your switch driver channel menu. Card 2 would correspond to channels 200 to 230; card 3, 300 to 330, and so forth up to card 8, 800 to 830. All of these channels are set with the drive enabled.

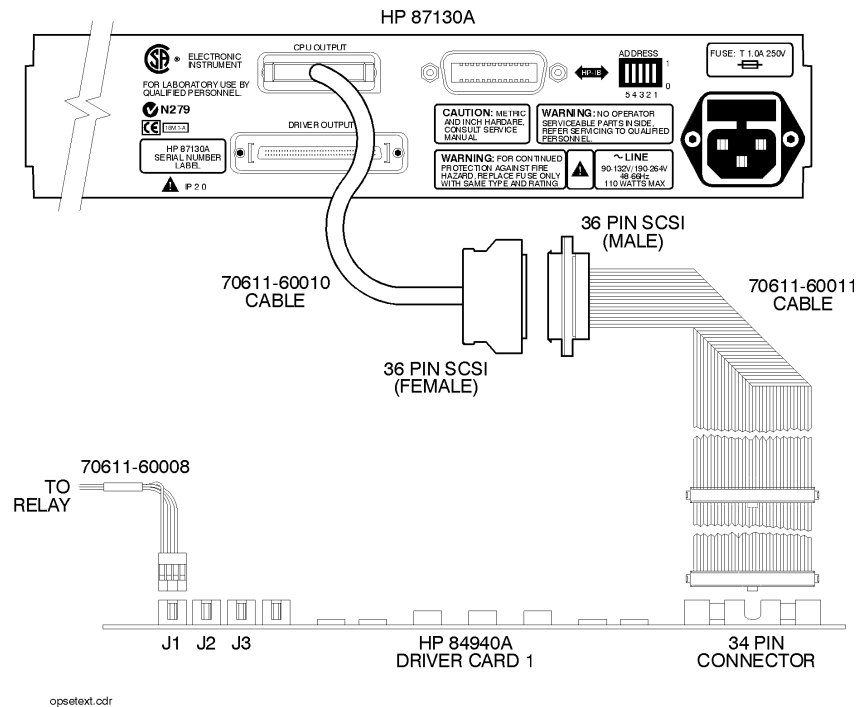

Figure 2-3 *Typical Operating Setup Using External Drivers*

The HP 84940A driver board includes the following items:

Description	Quantity	Part Number
Driver board	1	HP 84940A
Cable, 36-pin to 36-pin SCSIII, female, 5 feet, 28 AWG	1	70611-60010
Cable, 34-pin to 36-pin SCSIII, 18 inches., 28 AWG	1	70611-60011
Ribbon cable kit, 36-pin to 34-pin, 6 feet, , 28 AWG	1	70611-60013

Wiring Channel Connectors

When installing the switch driver, it is imperative to know which wires will cause an OPEN or CLOSE condition on each switch.

- An OPEN condition is defined as the black wire from J1 pin 1 is active-to-common (+24 Vdc red wire).
- A CLOSE condition is defined as the white wire from J1 pin 3 is active-to-common (+24 Vdc red wire).

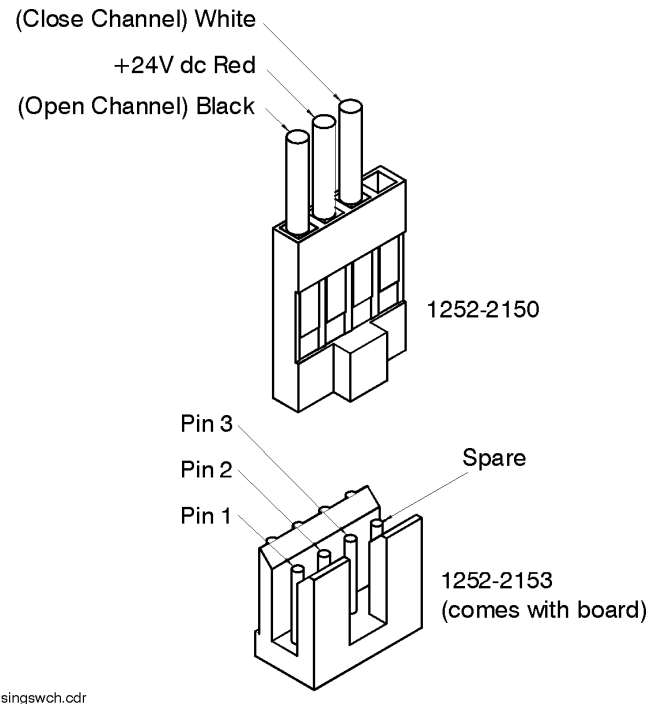

Figure 2-4 Typical Single Switch Channel Connector

CAUTION

Miswiring the +24V wire will cause a catastrophic driver board failure. On the standard switch driver, the recommended repair of this kind of failure is replacing the HP 84940A driver board assembly. The recommended repair procedure for an HP 87130A is to return the switch driver to Hewlett-Packard for repair.

Connecting Multiple Driver Cards

The cards are numbered from 1 to 8; the relays on each card are numbered from 0 to 30. Each relay is referred to as a *channel* by the switch driver. Therefore, there are a total of 248 relays (channels) that can be driven from a single switch driver.

In a single enclosure, place connectors (HP part number 1251-7090) on ribbon cables (HP part number 70611-60013) to daisy chain driver cards.

To reliably install the 34-pin connector to the ribbon cable use the following 3M™ tools. (To order from 3M™, call 1-800-225-5373).

Item	3M™ Part Number
Platen	3442-1A
Locator plate	3443-94
Hand press	3540

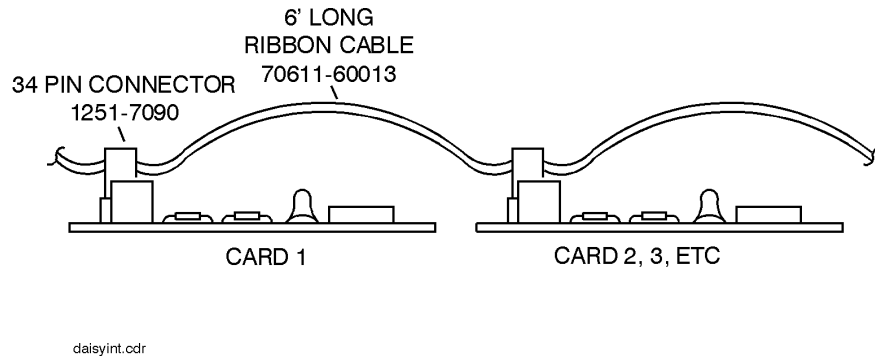

Figure 2-5 *Daisy Chain of Driver Cards in Single Enclosure*

Use the cables shown below to connect HP 84940A external cards to expand drive capability in different enclosures.

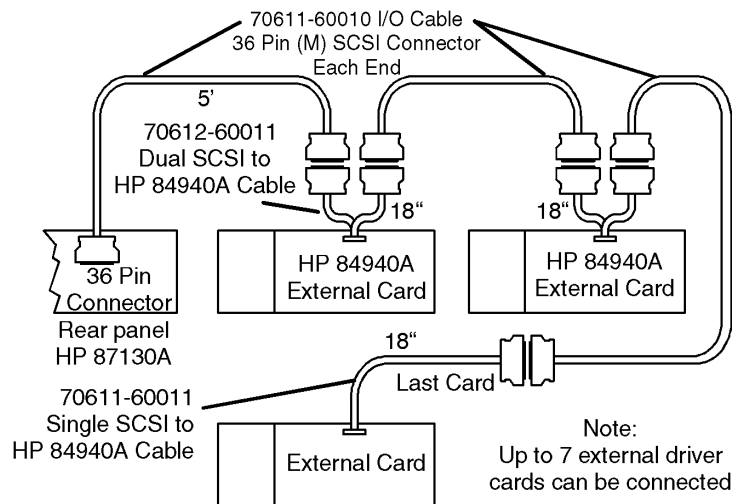

Figure 2-6 *Daisy Chain of Driver Cards in Different Enclosures*

Connecting Attenuators

Connect attenuator cables using a Viking connector and a ten pin connector. A typical connection of four section attenuators is shown below.

CAUTION

Make sure the switch driver is OFF before adding or removing relays or a miswiring of the +24 V can occur. Miswiring the +24 V red wire will cause a catastrophic driver board failure.

When connecting attenuators

- A CLOSE position should add attenuation.
- An OPEN position should remove attenuation.

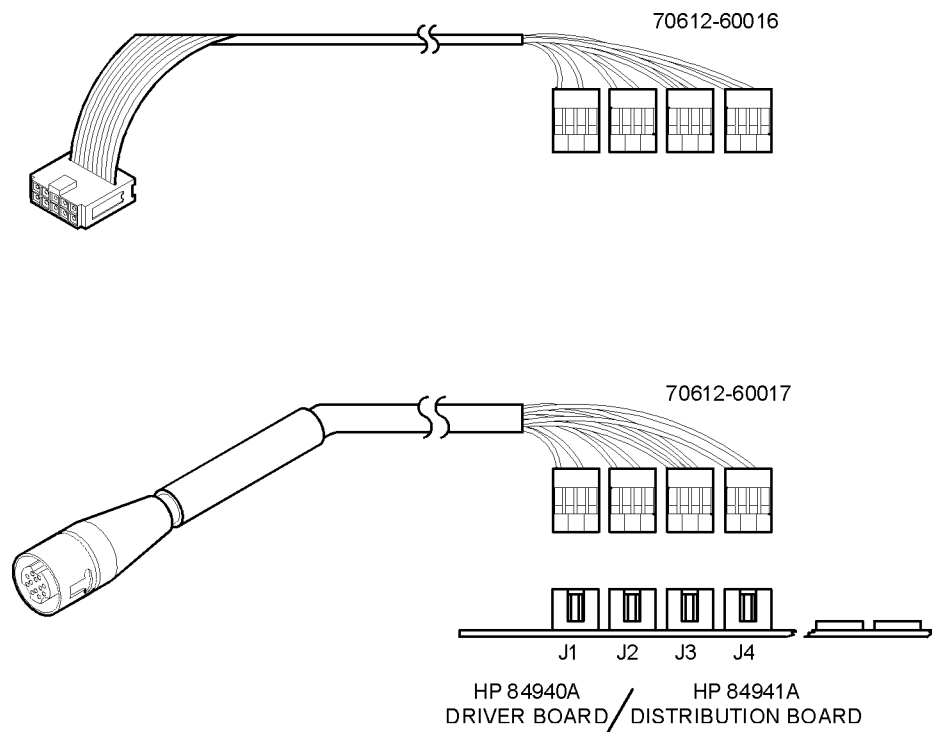

attcon.cdr

Figure 2-7 Typical Attenuator Cables Connected to an HP 84940A

Optimizing Switching Speed

To increase the speed at which your switch matrix operates, refer to the table below to determine which four relays, when connected, will be on the same drive lines.

- a. Refer to Figure 2-4 to wire your relays into the arbitrary positions of OPEN and CLOSE.
- b. Refer to the “Example Speed Calculation” at the end of Chapter 6, “Remote Operation” for an explanation on calculating and minimizing overall switching time.

Switching speed is a function of pulse widths, sensing delays, the state of the chosen channels, and the sequence of relays driven. Pulse widths, sensing delays, and which channels are opened or closed are determined by the user, and cannot be predicted here.

The switch driver’s power supply limits the switch driver to a total of 800 mA to drive relays at any one time. This means that four throws of 200 mA each is the limit for one switching operation.

NOTE

The channel number must be preceded by the driver card number. Channels connected to driver card 1 would be numbered 100 to 130; card 2, 200 to 230; card 3, 300 to 330, and so forth up to card 800 to 830. All of these channels are set with the drive enabled.

Table 2-1 *Relay Drive Sequence*

Drive Line	Connector Locator	Channel List
1	J1, J2, J3, J4	00, 01, 02, 03
2	J5, J6, J7, J8	04, 05, 06, 07
3	J9, J10, J11, J12	08, 09, 10, 11
4	J13, J14, J15, J16	12, 13, 14, 15
5	J17, J18, J19, J20	16, 17, 18, 19
6	J21, J22, J23, J24	20, 21, 22, 23
7	J25, J26, J27, J28	24, 25, 26, 27
8	J29, J30, J31	28, 29, 30

Driver Card Address

Set the 4-bit DIP switch on the HP 84940A driver assembly card to each address as shown in the figure below. (S1 “up” is open or away from the PC board.)

Each card must have a unique address setting. The internal driver is set to card 1.

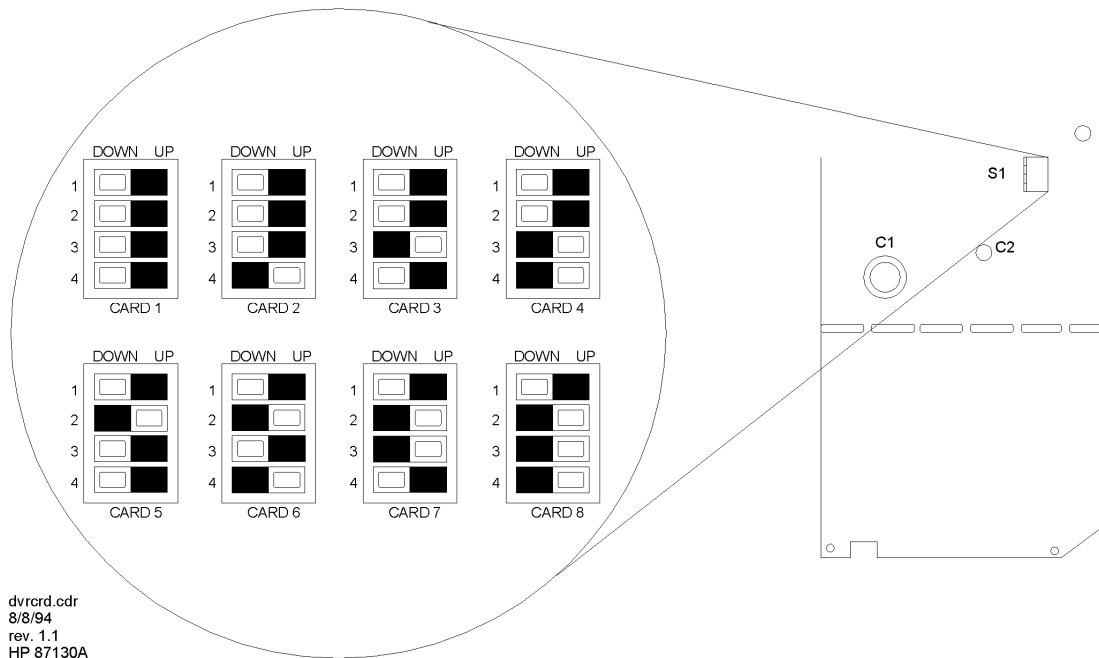

Figure 2-8 Eight Driver Card Addresses

It is impossible to predict the exact configuration of your particular switch matrix. It is assumed that each HP 84940A driver assembly will be in a separate grounded switch matrix box.

Driver Cable and Switch Cable Length Limitations

When you connect multiple driver boards and switches at a distance from the HP 87130A, voltage drop limitations due to switch drive and quiescent current, drive transistor drop, cable resistance, and LED current must be taken into account.

For instance, Hewlett-Packard “24 volt” switches are guaranteed to work with a minimum drive voltage of 20 volts. The HP 87130A puts out 24 V, and the open collector output transistors of each channel on the driver boards have a drop of 1.3 V. Thus 2.7 V is left for the total voltage drop for driver board cables and switch wires.

For example, a seventh external driver board, “fully loaded” with seven HP 87104A switches (maximum 350 mA quiescent current plus 400mA

Connecting Switch Drivers to Switches and Attenuators

actuating current) located at the end of the sequence of HP 70611-60010, 70611-60011, and 70612-60011 cables of #28 AWG wire size, at a total cable length of 62.5 feet from the HP 87130A would have a voltage of 20.4 volts available at the driver board. ($22.7 \text{ V} - (750 \text{ mA} \times 0.065 \text{ ohms per foot} \times 62.5 \text{ feet} \times 0.75)$).*

This leaves 0.4 V that can be dropped in the wires from the board to the switches. Thus, if each switch has 400mA actuating plus 50 mA quiescent current, a combined length of 22 feet of #26 AWG wire would be the maximum length permissible to meet switch specifications. ($450 \text{ mA} \times 0.04 \text{ ohms per foot} \times 22 \text{ feet} = 0.4\text{V}$). Any LED current must also be added to these calculations.

Special longer lengths of heavier-gauge driver (68 pin) and CPU (36 pin) cables are available. Refer to “Service and Support” on page v for ordering information.

* This calculation makes two assumptions:

- (1) There are no other devices which consume quiescent current connected to the driver boards between the HP 87130A and the seventh driver board.
- (2) The factor 0.75 in this equation is used to calculate an “equivalent” cable length for forward and return path since there are two +24V lines in parallel and 4 return lines in parallel.

Pin Functions for 36-Pin I/O Data Cable

- The standard switch driver has a high density male, 36-pin SCSI II type connector.
- The standard I/O data cable is a five-foot 28 AWG cable with two female, 36-pin SCSI II type connectors.

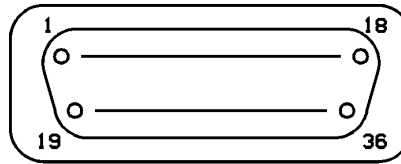
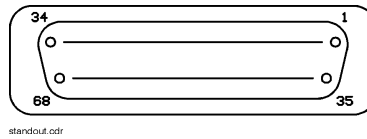

Table 2-2 *Standard 36-Pin (Male) SCSI II Type Connector Pin Functions*

Pin	Function	Pin	Function
1	Return	19	D6,Data Line
2	Return	20	D7,Data Line
3	NC	21	D8,Data Line
4	NC	22	D9,Data Line
5	NC	23	D10,Data Line
6	NC	24	D11,Data Line
7	+5 Vdc	25	D12,Data Line
8	+5 Vdc	26	D13,Data Line
9	+24 Vdc	27	D14,Data Line
10	+24 Vdc	28	NC
11	Return	29	NC
12	Return	30	Register CLR
13	D0,Data Line	31	Store
14	D1,Data Line	32	I/O
15	D2,Data Line	33	Return
16	D3,Data Line	34	Return
17	D4,Data Line	35	NC
18	D5,Data Line	36	NC

Pin Functions for 68-pin Driver Output Connector



- The driver board has a 68-pin connector for driving attached switches.
- The standard output cable for the HP 87130A is a six-foot 28 AWG cable with two male 68-pin SCSI II type connectors.
- When you wire the switch driver to the switches, use the following table to define an OPEN or CLOSE position.

Table 2-3 68-Pin (Female) SCSI II Type Connector Pin Functions

Pin	Function	Pin	Function
1	Return	35	Return
2	Channel 0, Open	36	Channel 0, Close
3	Channel 1, Open	37	Channel 1, Close
4	Channel 2, Open	38	Channel 2, Close
5	Channel 3, Open	39	Channel 3, Close
6	Channel 4, Open	40	Channel 4, Close
7	Channel 5, Open	41	Channel 5, Close
8	Channel 6, Open	42	Channel 6, Close
9	Channel 7, Open	43	Channel 7, Close
10	Channel 8, Open	44	Channel 8, Close
11	Channel 9 Open	45	Channel 9, Close
12	Channel 10, Open	46	Channel 10, Close
13	Channel 11, Open	47	Channel 11, Close
14	Channel 12, Open	48	Channel 12, Close
15	Channel 13, Open	49	Channel 13, Close
16	Channel 14, Open	50	Channel 14, Close
17	Channel 15 Open	51	Channel 15, Close
18	Channel 16, Open	52	Channel 16, Close
19	Channel 17, Open	53	Channel 17, Close
20	Channel 18, Open	54	Channel 18, Close
21	Channel 19, Open	55	Channel 19, Close
22	Channel 20, Open	56	Channel 20, Close
23	Channel 21, Open	57	Channel 21, Close
24	Channel 22, Open	58	Channel 22, Close
25	Channel 23, Open	59	Channel 23, Close
26	Channel 24, Open	60	Channel 24, Close
27	Channel 25, Open	61	Channel 25, Close
28	Channel 26, Open	62	Channel 26, Close
29	Channel 27, Open	63	Channel 27, Close
30	Channel 28, Open	64	Channel 28, Close
31	Channel 29, Open	65	Channel 29, Close
32	Channel 30, Open	66	Channel 30, Close
33	+24 Vdc	67	+24 Vdc
34	Return	68	Return

3

Specifications

Overview

Performance specifications are the performance standards or limits against which the HP 87130A can be tested. The specifications are organized into two categories:

- Characteristics which provide useful but non-warranted functional and performance information for the HP 87130A
- Measurement related specifications which describe warranted performance for the HP 87130A over the temperature range of 0° C to +55° C after one hour of continuous operation, unless otherwise noted

Performance Specifications

Table 3-1 HP 87130A Electrical Specifications

Electrical Specifications	
Drive Capacity - HP 87103A	248 relays, when mated with seven external HP 84940A daisy chained driver cards. Each HP 84940A can drive up to 31 relays. The equivalent of one HP 84940A driver card is installed within the HP 87130A.
Voltage	+24 \pm 3.0 Vdc
Current Pulses	800 mA maximum per four relay group 200 mA per relay (400 mA per multithrow switch such as HP 87104) <i>Pulse width is adjustable for 5 ms to 1275 ms \pm5 ms, in 5 ms steps.</i>
Load Inductance	<i>Typically < 500 mH.</i>
Load Capacitance	<i>Typically < 0.01 μF</i>
Switching Speed	Sensing delay is adjustable, per relay, from 5 to 1275 ms \pm 5 ms. Pulse width is also adjustable, per relay, from 5 to 1275 \pm 5 ms. <i>Refer to Chapter 6, "Example Speed Calculation". The final switching speed is a function of pulse widths, sensing delays, the sequence of relays driven, and the state of the chosen channels.</i>
Remote Programming	All functions are HP-IB programmable except the line switch and bus address. All functions are programmable to conform with IEEE 488.2-1987 Standard Commands for Programmable Instruments (SCPI). The HP 87130A can output over the interface almost all settings, error/malfunction codes and operational status codes.
Interface to controller	HP-IB
Interface to external driver cards	36-pin SCSI II type
Interface to relays	68-pin SCSI II type

Table 3-2 HP 87130A Environmental Specifications

Environmental Specifications	
Temperature	
Operating	0° C to +55° C
Non-operating	-40° C to 70° C
Humidity	
Operating and	
Non-operating	80% relative humidity up to 31 ° C decreasing linearly to 50% relative humidity at 40° C
Altitude	
Operating and non-operating	5600 meters (15,000 feet)
Environmental Compatibility	Radiated and conducted emission is in compliance with CISPR Pub 11/1990, Group 1, Level A
Environmental Qualification Test	
Humidity	5 day, 25-40° C, 50 to 95% relative humidity
Vibration	a. Operating: MIL-PRF-28800F, Class 3, par. 4.5.5.3.1 (random, 10 to 500 Hz, 0.21 g rms) b. Non-operating: swept sine, 5 to 500 Hz, 0.5g, 15 min/axis, 3 axis c. Non-operating: MIL-PRF-28800F, Class 3, par. 4.5.5.3.1 (random, 10 to 500 Hz, 2.1 g rms)
Shock	a. Non-operating, 170 g, 1/2 sine 2ms, 1 drop/face, 6 faces b. Non-operating, 30 g, trapezoidal, 28 ms, 1 drop/face, 6 faces
Environmental Conditions	This product is designed for indoor use in Installation Category II and Pollution Degree 2 per IEC 1010 and IEC 664, respectively. Enclosure protection is IP 2 0 according to IEC 529.
Line Voltage	100 to 240 Vac
Power Consumption	110 Watts MAX
Weight	6.2 kg (16.5 lb)
Dimensions	10.2 cm (h) x 45.7 cm (w) X 55.9 cm (d) (4 in. x 18 in. x 22.5 in)

Specifications
Performance Specifications

4

Verification

Overview

In this chapter you will learn about:

- When to test the electrical performance of the HP 87130A
- What equipment is needed
- How to perform the test

Performance Tests

Run performance tests for incoming inspection, troubleshooting, or preventive maintenance to test the electrical performance of the HP 87130A.

The specifications listed in Chapter 3 are used as the performance standards.

Conditions

If the performance tests are to be considered valid, the following conditions must be met:

- The HP 87130A must have one-half hour warm-up.
- The ambient temperature must be 0° to 55° C.
- The HP 87130A must pass all self tests.
- During any performance test, all shields and connecting hardware must be in place.
- Proper cables, adapters, and probes must be used for the test setups.
- The user must understand how to operate the specified test equipment needed for each test.

Recommended Test Equipment

Recommended test equipment for the verification tests is given below. Other equipment may be substituted if it meets or exceeds the critical specifications listed.

Table 4-1 Recommended Test Equipment for HP 87130A

Instrument	Critical Specifications	Recommended Model	Use ¹
External Driver	No substitute	HP 84940A	O, P, T
PC or UNIX platform	Must have HP-IB controller and software capability	UNIX workstation with RMB ² or PC with HP-IB and HP Basic for Windows capability	O, P, T
Oscilloscope	Bandwidth: dc - 100 MHz Vertical sensitivity: 5 V/div Vertical input: 50Ω impedance dc coupled Timebase: 5 ms/div	Various models	P, T
Service Aid	No substitute	HP 70611-60014	P, T
Cable	No substitute	HP 70611-60010	P, T
Cable	No substitute	HP 70611-60004	P, T

¹P = Performance tests, T = Troubleshooting, O = Operator's checks

²Rocky Mountain Basic

Pulse Parameters Test

The pulse parameters test verifies the drive pulse parameters as delivered to the switches from the rear panel and from an external HP 84940A.

One channel (capable of driving four switches) is tested for switching speed at 30 ms (sensing disabled), voltage at +24 Vdc, and current at 200 mA for each switch (800 mA for all four switches.).

Table 4-2 *Specification*

Electrical Characteristics	Performance Limits	Conditions
Switching Speed:	0.050 ±0.005 s	(User set), Pulse width + delay
<i>Pulse width:</i>		
Maximum:	1.275 ±0.005 s	
Minimum:	0.005 ±0.005 s	
Default:	0.030 ±0.005 s	
<i>Sensing delay:</i>		
Maximum:	1.275 ±0.005 s	
Minimum:	0.005 ±0.005 s	
Default:	0.020 ±0.005 s	
Power:		
Voltage:	+24 ±3.0 Vdc	
Current:	800 mA maximum	200 mA per relay

Hardware Limits

The +24 volt supply in the switch driver can supply sufficient current to drive up to four HP 33311/8762 Series relays at one time.

Each open collector driver IC can drive only one channel (a maximum of four switches) at a time to avoid exceeding package dissipation limits.

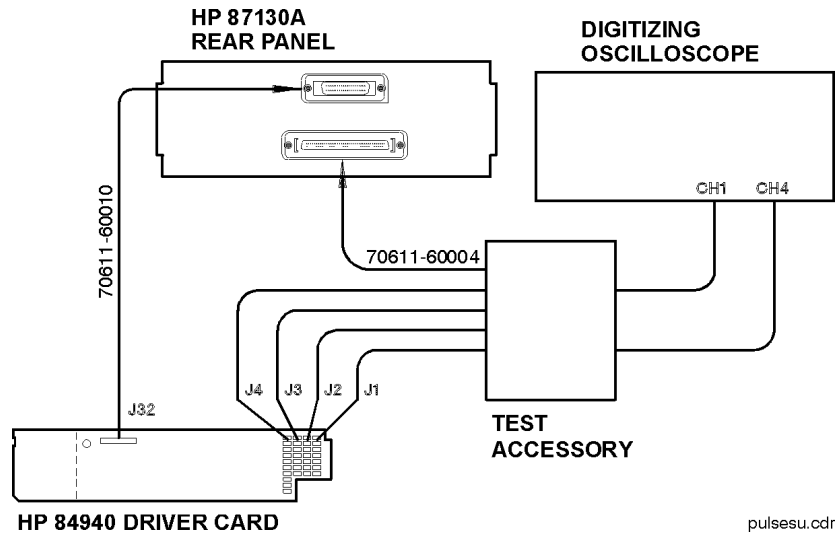

pulsesu.cdr

Figure 4-1 Pulse Parameters Test Setup

Equipment

Controller	Refer to Table 4-1.
Oscilloscope	Refer to Table 4-1.
Service Aid ¹	70611-60014
Driver Board	HP 84940A
Cable	70611-60004
Cable	70611-60010

¹This test accessory provides a 200 mA load for the driver.

Procedure

1. Set the switch driver power switch to OFF.

CAUTION

Do not connect or disconnect relays while the switch driver's LINE switch is ON, or an unintentional short to +24 V could occur. This will cause a catastrophic driver board failure.

2. Connect the equipment as shown in Figure 4-1. (In this example, the HP-IB address is set to 9.)
 - If you are using an external driver, connect the test accessory to J1, J2, J3, J4. Connect cable (HP part number 70611-60010) from the CPU output of the HP 87130A to the HP 84940A driver card at J32.

- If you are using an HP 87130A without an external driver, connect the test accessory with cable (HP part number 70611-60004) to the driver output of the HP 87130A.
- Set the oscilloscope as follows:
 - Volts/div 5V
 - Sweep speed 10 ms per div
 - Trigger INTERNAL

3. Set the systems's LINE switch ON.

If you are using a platform with HP-IB controller capability and HP Basic, you may use the following program:

```

10  OUTPUT 709:"*RST"
20  OUTPUT 709;"ROUT:DRIV:ON (@100:103);"
30  OUTPUT 709;"ROUT:DRIV:OFF (@104:130);"
40  !
50  !  OUTPUT 709;"ROUT:VER:ON (@100:103);"
60  !
70  !  For the Sensing (:VERify) Disabled test, comment out
80  !  line 50 and leave line 100 in the program,
90  !  as shown here.
100 OUTPUT 709;"ROUT:VER:OFF (@100:103);"
110 !
120 !  For the Sensing (:VERify) Enabled test, comment out
130 !  line 100 and leave line 50 in the program.
140 !
150 OUTPUT 709;"ROUT:WIDT .03,(@100:103);"
160 !
170 !  This sets the pulse (:WIDTh) to the default 30 ms.
180 !
190 OUTPUT 709;"ROUT:DEL .02,(@100:103);"
200 !
210 !  This sets the sensing (:DELay) to the default 20 ms.
220 !  When sensing (:VERify) is OFF (line 100), (:DEL) does
230 !  not apply.
240 !  Switching speed is then the 30 ms pulse (:WIDTh).
250 OUTPUT 709;"ROUT:CLOS (@100:103);"
260 PAUSE
270 OUTPUT 709;"ROUT:OPEN (@100:103);"
280 END

```

Pulse Parameters Test**Voltage**

1. Set the oscilloscope to 5 V/div.
2. Read the oscilloscope.
3. Record the reading. +21 V < _____ < 27 V

Current

Divide the voltage by 120Ω to get the value of the current.

200 mA < _____

Switching Speed (sensing disabled)

1. Set the switch driver to 30 ms pulse width.
2. Set the oscilloscope to 5 ms/div.
3. Read the oscilloscope.
4. Record this reading. 25 ms < _____ < 35 ms

Switching Speed (sensing enabled)

1. Set the switch driver to 20 ms Delay.
2. Set the oscilloscope to 10 ms/div.
3. Read the oscilloscope.
4. Record this reading. 45 ms < _____ < 55 ms

HP 87130A Range	Minimum	Actual Results	Maximum
Voltage	21 Vdc		27 Vdc
Current	175 mA		225 mA
Switching Speed:			
Sensing Disabled	25 ms		35 ms
Sensing Enabled	45 ms		55 ms

Sensing Disabled

Each switch coil is internally connected between the +24 V bias supply. A power transistor on the switch driver board provides the ground return path for the coil. The power transistor is actuated by control logic that is nominally set to provide a pulse width of 30 ms for actuating the electro-mechanical switch.

Sensing Enabled

The switch should be driven an additional 20 ms after the initial 30 ms closure pulse to allow sense lines to settle. At this time an error and a programmed position check are performed. The combined time for the switch driver to close a switch and verify its position is 50 ms.

5

Local Operation

The information normally contained in this chapter does not apply to this instrument.

Overview

In this chapter you will learn about programming the HP 87130A using a controller:

- How to set up the switch driver and start programming groups and paths for switches
- How to set switch delay, pulse width, and sensing
- How to sense switch status
- How to store and retrieve switch parameters via remote interface
- How to perform more complicated tasks using a combination of these four basic functions

You will also find:

- A command tree of SCPI commands
- An alphabetical list of common commands
- An alphabetical list of SCPI commands
- Three programming examples:
 - Save memory
 - Restore memory
 - Speed calculation

Programming

Standard Commands

The instrument command language is Standard Commands for Programmable Instruments (SCPI).

The programming examples and information in this chapter use the SCPI format. SCPI follows IEEE 488.2-1987 Codes, Formats, Protocols and Common Commands. Commands are sent over an HP-IB bus which follows IEEE 488.1.

If you are already familiar with Standard Commands for Programmable Instruments (SCPI) programming techniques, go to the “Speed Calculation Example” at the end of this chapter for switching speed information. The alphabetical listing of commands and command tree can be used for your own applications.

Language

The programming examples in this manual are written in HP BASIC 5.0 for HP-IB.

HP BASIC handles some of the redundant miscellaneous overhead associated with IEEE Standard 488.1 (HP-IB). For instance, when a BASIC OUTPUT statement is used (by the active controller) to send data to an HP-IB device, a sequence of commands and data are sent over the bus. The HP BASIC OUTPUT statement causes more than just the output of data to take place.

```
OUTPUT 709 "Data"
```

1. The unlisten command is sent.
2. The talker's address command is sent (the address of the computer).
3. The listener's address command (09) is sent.
4. The data bytes “D”, “a”, “t”, and “a” are sent.
5. Terminators CR and LF are sent.

All bytes are sent using the HP-IB's interlocking handshake to ensure that the listener has received each byte.

For controllers other than Hewlett-Packard which are using a programming language other than HP BASIC, additional steps may have to be added to the program examples given in this manual. For more information, refer to IEEE Standard 488.1 (HP-IB) and IEEE Standard 488.2-1987 Codes, Formats, Protocols and Common Commands.

Programming Syntax

Talking to the Switch Driver

In general, computers acting as controllers communicate with the switch driver by passing messages over a remote interface using the I/O statements provided in the instruction set of the controller's host language. Therefore, the messages for programming the switch driver described in this manual, will normally appear as ASCII character strings imbedded inside the I/O statements of your controller's program.

For example, the HP 9000 Series 300 BASIC and PASCAL language systems use the `OUTPUT` statement for sending program messages to the switch driver, and the `ENTER` statement for receiving response messages from the switch driver.

Messages are placed on the bus by using an output command and passing the device selector, program message, and terminator. Passing the device selector ensures that the program message is sent to the correct interface and instrument.

Example The following query command reads out the firmware datecode:

```
OUTPUT <device selector>:" :SYSTEM:VERSION?"
```

where <device selector> represents the address of the device being programmed.

Programming Conventions

The programming examples in this manual are written in HP Basic 5.0 for an HP-IB controller compatible system.

- The actual `OUTPUT` command used when programming is dependent on the controller and the programming language being used.
- Angular brackets "< >," in this manual, enclose words or characters that symbolize a program code parameter or a bus command.
- Information that is displayed in quotes represents the actual message that is sent across the bus. The message terminator (NL or EOI) is the only additional information that is also sent across the bus.
- On most controllers, it is not necessary to type in the actual <terminator> at the end of the program message. These controllers automatically supply the program message terminator when the return key is pressed.

Addressing the Switch Driver

Since HP-IB can address multiple devices through the same interface card, the device selector passed with the program message must include not only the correct interface code, but also the correct instrument address.

Interface Select Code (Selects Interface)

Each interface card has a unique interface select code. This code is used by the controller to direct commands and communications to the proper interface. The default is typically 7 for HP-IB controllers.

Instrument Address (Selects Instrument)

Each instrument on an HP-IB bus must have a unique instrument address between decimal 0 and 30. The address must not be the address of the controller. (Refer to Chapter 2, “Installing the HP 87130A Attenuator/Switch Driver”.) The device address passed with the program message must include *both* the correct instrument address *and* the correct interface select code.

Example $\text{DEVICE SELECTOR} = (\text{Interface Select Code} \times 100) + (\text{Instrument Address})$

If the instrument address for the switch driver is 9 and the interface select code is 7, when the program message is passed, the routine performs its function on the instrument at device selector 709.

For the switch driver, the instrument address is typically set to 9 at the factory. *The program examples in this manual assume the switch driver is set to device address 709.*

Program Message Syntax

To program the switch driver over the bus, you must have an understanding of the command format and structure expected by the switch driver.

The switch driver is remotely programmed with program messages. These are composed of sequences of program message units, with each unit representing a program command or query.

A program command or query is composed of a sequence of functional elements that include separators (a blank space which is required to separate the program mnemonic from the program data), headers, program data, and terminators. These elements are sent to the switch driver over the system interface as a sequence of ASCII data messages.

Commands

A command is composed of a header, any associated data, and a terminator. The header is the mnemonic or mnemonics that represent the operation to be performed by the switch driver. The different types of headers are discussed in the following paragraphs.

Compound Command Header

Compound command headers are a combination of two or more program mnemonics. The first mnemonic selects the subsystem, and the last mnemonic selects the function within that subsystem. Additional mnemonics appear between the subsystem mnemonic and the function mnemonic when there are additional levels within the subsystem that must be transversed. The mnemonics within the compound message are separated by colons.

Example To execute a single function within a subsystem:

```
:<subsystem>:<function><separator><program data><terminator>
ROUTE:GROUP <group name>:AUTOSELECT:OFF;
```

Example To transverse down a level of a subsystem to execute a subsystem within that subsystem:

```
:<subsystem>:<subsystem>:<function><separator><program data>
<terminator>
ROUTE:GROUP:LABEL "Atten 0 to 110 dB by 10 dB steps";
```

Selecting Multiple Subsystems

You can send multiple program commands and program queries for different switch driver subsystems on the same line by separating each command with a semicolon.

Example The colon following the semicolon enables you to enter a new subsystem.

```
:<subsystem>:<function><separator><data>;
<function><separator><data><terminator>
ROUTE:DRIVE:OFF:ALL;;:SYSTEM:VERSION?
```

Common Command Header

Common command headers control IEEE 488.2 functions within the switch driver (such as clear status, etc.). Their syntax is:

```
*<command header><terminator>
```

No space or separator is allowed between the asterisk and the command header.

Example *CLS is an example of a common command header.

```
*CLS; ROUTE:DRIVE:ON (@100,102,104,106,...);
```

Common commands used by the switch driver are explained in more detail in the “Common Command Reference” later in this chapter.

Program Header Options

Program headers can be sent using any combination of uppercase or lowercase ASCII characters.

Both program command and query headers may be sent in either longform (complete spelling), shortform (abbreviated spelling), or any combination of longform and shortform.

NOTE

ONLY the longform or shortform of a command will be accepted by the switch driver. Either of the following examples read out the firmware datecode:

```
SYSTEM:VERSION? – longform
```

```
SYST:VERS? – shortform
```

- Programs written in longform are easy to read and are almost self-documenting.
- The shortform syntax conserves the amount of controller memory needed for program storage and reduces the amount of I/O activity. The shortform abbreviation is given for each command in the “SCPI Command Reference.”

Program Data

Program data is used to convey a variety of types of parameter information related to the command header. At least one space must separate the command header or query header from the program data.

```
<program mnemonic><separator><data><terminator>
```

When a program mnemonic or query has multiple data parameters, a comma separates sequential program data.

Example <program mnemonic><separator><data>,<data><terminator>

```
ROUTE:DELAY .02,(@101,103,105);
```

Character Program Data

Character program data is used to convey parameter information as alpha or alphanumeric strings.

Example `ROUTE:VERIFY:ON:ALL`

The `:VERIFY` function is specified to be `ON` for `ALL` channels.

Numeric Program Data

Some command headers require program data to be a number.

Example `ROUTE:DELAY .03,(@101,103,105)`

where the `:DELAY` function is specified to be 30 ms on channels 101, 103, and 105.

Program Message Terminator

The program codes within a data message are executed after the program message terminator is received. The terminator may be either an NL (New Line) character, an EOI (End-Of-Identify) asserted, or a combination of the two. All three ways are equivalent. Asserting EOI sets the HP-IB EOI control line low on the last byte of the data message. The NL character is an ASCII linefeed (decimal 10).

Query Command

Command headers immediately followed by a question mark (?) are queries. Query commands are used to find out how the switch driver is currently configured. After receiving a query, the switch driver interrogates the requested function and places the answer in its output queue. The output message remains in the queue until it is read or another command is issued. When read, the message is transmitted across the bus to the designated listener (typically a controller).

Example The query `ROUTE:PATH:VALUE? <path name>` places the value of the named path in the output queue. In conjunction with this, the controller input statement:

```
ENTER <device selector>;Values$
```

passes the value across the bus to the controller and places it in the BASIC variable "Values\$".

Query commands are also used to get results of switch status made by the switch driver, with the query actually activating the switch.

Example

```
ROUTE:CLOSE? <channel spec>
```

instructs the driver to sense the status of the switch and place the result in the output queue.

The output queue must be read before the next program message is sent.

Example

When the query

```
ROUTE:VERIFY:ON?
```

is sent, that query must be followed with a program statement like,

```
ENTER 709;Verify$
```

to read the result of the query and place the result in a BASIC variable (Verify\$).

Sending another command before reading the result of the query will cause the output buffer to be cleared and the current response to be lost. This will also generate an error in the error queue.

Programming the Switch Driver

Initialization

To make sure the bus and all appropriate interfaces are in a known state, begin every program with an initialization statement.

Example

```
CLEAR 709 ! initializes the interface of the driver.
```

Then initialize the switch driver to a preset state. For example:

```
OUTPUT 709;"*RST" ! initializes the instrument to a preset state.
```

The actual commands and syntax for initializing the switch driver are discussed in the section on “Common Commands.” Refer to the controller manual for information on initializing the interface.

Setting Up the Switch Driver

A typical switch driver setup would set the drive (ON or OFF) paths, delay time, sensing (ON or OFF), and pulse width. Some typical examples of the commands sent to the driver are:

```
OUTPUT 709;"*CLS;ROUTE:DRIVE:ON (@100,102,104,106,...);"
OUTPUT 709;"ROUTE:DRIVE:OFF (@101,103,105,107,...);"
OUTPUT 709;"ROUTE:VERIFY:ON (@100,102,104,106,...);"
OUTPUT 709;"ROUTE:WIDTH .04,(@100,102,104,106,...);"
OUTPUT 709;"ROUTE:DELAY .03,(@100,102,104,106,...);"
```

Receiving Information from the Switch Driver

After receiving a query (command header followed by a question mark), the switch driver interrogates the requested function and places the answer in its output queue. The answer remains in the output queue until it is read or another command is issued. When read, the message is transmitted across the bus to the controller.

The input statement for receiving a response message from an instrument's output queue typically has two parameters; the device address and a format specification for handling the response message.

Example

To read the result of the query command

```
:GROUP:LABEL?
```

you would execute the statement:

```
10 OUTPUT 709;"ROUT:GROUP:LABEL? GROUP1"
20 ENTER 709;Setting$
```

where `GROUP1` represents the name of the desired group. This would enter the current label of the group in the string variable `Setting$`.

Example All results for queries sent in a program message must be read before another program message is sent.

When you send the query: `ROUTE:CLOSE? (@101)`

you must follow that query with the program statement:

```
ENTER 709;Sense$
```

to read the result of the query and place the result in a variable (`SENSE$`).

- Sending another command before reading the result of the query will cause the output buffer to be cleared and the current response to be lost. This will also cause an error to be placed in the error queue.
- Executing an `ENTER` statement before sending a query will cause the controller to wait indefinitely.

NOTE

- The actual `ENTER` program statement used when programming is dependent on the programming language being used.
- The format specification for handling the response message is dependent on both the controller and the programming language.

String Variables

If you want to observe the headers for queries, you must bring the returned data into a BASIC string variable. Reading queries into string variables is simple and straightforward, requiring little attention to formatting.

Example

```
ENTER 709;Result$
```

places the output of the query in the string variable `Result$`.

The output of the switch driver may be either numeric or character data depending on what is queried. Refer to the specific commands for the formats and types of data returned from queries.

For the example programs, assume that the device being programmed is at device selector 709. The actual address will vary according to how you have configured the bus for your own application.

Example

This example shows the data being returned to a string variable:

```
10 DIM Rang$[40]
20 OUTPUT 709;"ROUTE:VERIFY:OFF:ALL;"
30 OUTPUT 709;"ROUTE:VERIFY:OFF? (@101:105);"
40 ENTER 709;Rang$
50 PRINT Rang$
60 END
```

After running this program, the controller displays a list of 1's or 0's separated by commas for every channel in the list.

```
1,1,1,1,0
```

Instrument Status

Status registers track the current status of the switch driver. By checking the instrument status, you can find out whether an operation has been completed, whether the switch driver is receiving triggers, and query for command and execution errors. Refer to the `*ESR?` command for more information.

Common Commands Reference

The common commands used in this instrument are shown in the following table.

- The common commands control some of the basic instrument functions, such as instrument identification and reset and how status is read and cleared.
- The common commands are defined by the IEEE 488.2 standard and are common to all instruments that comply with this standard.

Table 6-1 *IEEE 488.2 Common Commands*

Command	Command Name
*CLS	Clear Status Command
*ESE	Event Status Enable Command
*ESE?	Event Status Enable Query
*ESR?	Event Status Register Query
*IDN?	Identification Query
*OPC	Operation Complete Command
*OPC?	Operation Complete Query
*RST	Reset Command
*SRE	Service Request Enable Command
*SRE?	Service Request Enable Query
*STB?	Read Status Byte Query
*TST?	Self-Test Query
*WAI	Wait-to-Continue Command

***CLS (Clear Status)**

Syntax

*CLS

Description

The *CLS (clear status) common command clears the status data structures, including the device defined error queue. This command also clears *OPC and *OPC? .

If the *CLS command immediately follows a PROGRAM MESSAGE TERMINATOR, the output queue and the MAV bit will be cleared.

Example Command

```
OUTPUT 709; ``*CLS``
```

***ESE (Event Status Enable)**

Syntax

`*ESE mask`

`*ESE?`

Description

The `*ESE` command sets the Standard Event Status Enable Register bits. This register contains a mask value for the bits to be enabled in the Standard Event Status Register. A one in the Standard Event Status Enable Register will enable the corresponding bit in the Standard Event Status Register; a zero will disable the bit.

Refer to the table below for the information about the Standard Event Status Enable Register bits, bit weights, and what each bit masks. Valid number range is 0 to 255.

The `*ESE` query returns the current contents of the register.

Table 6-2 *Event Status Enable Register Bit Definitions*

Bit	Weight	Enables
7	128	PON- Power ON
6	64	(not used)
5	32	CME- Command Error
4	16	EXE- Execution Error
3	8	DDE- Device Dependent Error
2	4	QYE- Query Error
1	2	(not used)
0	1	OPC- Operation Complete

Example Command

```
OUTPUT 709;"*ESE 64"
```

Example Query

```
OUTPUT 709;"*ESE?"
```

```
ENTER 709; Event
```

```
PRINT Event
```

***ESR? (Event Status Register Query)**

Syntax

*ESR?

Description

The *_{ESR} query returns the contents of the Standard Event Status Register.

The table shows each bit in the Event Status Register and the bit weight. When you read the Event Status Register, the value returned is the total bit weights of all bits that are high at the time you read the byte. The register is cleared to 0 on a *_{CLS} and after *_{ESR?} is executed.

Refer to the *_{STB?} command to learn how the _{ESR} is reported through the Status Byte.

Table 6-3 *Event Status Register Bit Definitions*

Bit	Weight	Name	Condition
7	128	PON	1 = an OFF to ON transition has occurred
6	64	URQ	(not used) always 0
5	32	CME	0 = no command errors 1 = a command error has been detected
4	16	EXE	0 = no execution errors 1 = an execution error has been detected
3	8	DDE	0 = no device dependent errors 1 = a device dependent error has been detected
2	4	QYE	0 = no query errors 1 = a query error has been detected
1	2	RQC	(not used) always 0
0	1	OPC	0 = operation is not complete 1 = operation is complete

Example Query

```
OUTPUT 709;"*ESR?"
ENTER 709; Event
PRINT Event
```

***IDN (Identification Number)**

Syntax

*IDN?

Description

The *IDN query allows the instrument to identify itself. It returns a string such as:

```
HEWLETT-PACKARD,87130A,US12345678,950713
```

Where 950713 is the firmware version number and US12345678 is the serial number.

Example Command

```
DIM Id$[72]  
OUTPUT 709;"*IDN?"  
ENTER 709;Id$  
PRINT Id$
```

*OPC (Operation Complete)

Syntax

*OPC

*OPC?

Description

The *OPC and *OPC? commands are used to synchronize remote interface software to internal module events.

- The *OPC (operation complete) command will cause the instrument to set the operation complete bit in the Standard Event Status Register when any switching operations that were in process at the time the *OPC command was received have completed.
- *OPC is also used to signal the end of MEM:SAVE operation.
- *OPC? causes a 1 to be put into the output buffer when any switching operations that were in process at the time the *OPC? command was received have completed.

If no switching operations were in process at the time the command was sent, the response will be generated immediately. Hence *OPC or *OPC? should only be sent after an operation has been initiated.

Example Command

```
OUTPUT 709;"*OPC"
```

Example Query

The following sequence is correct, because the OPC command is sent *after* the operation is initiated:

```
OUTPUT 709; "ROUT:CLOS (@1(1,3,5,7,9));*OPC?"  
ENTER 709;A  
PRINT A
```

The following sequence is incorrect, because the OPC command is sent *before* the operation is initiated:

```
*OPC?;ROUT:CLOSE (@1(1,3,5,7,9));
```

***RST (Reset)**

Syntax

*RST

Description

*RST is equivalent to a power up condition for the switch hardware.

All relays for which DRIVE is ON are set to the positions determined by ROUTE:PFail. For any relays not in either the ROUTE:PFail:OPEN or ROUTE:PFail:CLOSE list, the positions which are stored in the “last state” list in RAM are used to set the initial switch position. The “last state” list contains the programmed positions of the switch hardware that existed the last time a MEM:SAVE command or a SAVE TO EEROM keypress took place.

The setting of the switches during *RST or power up is done with VERIFY turned OFF, to get all the relays and sense lines into a known state. VERIFY is then turned on for any switches in the VERIFY list.

*RST affects only the switches themselves and does not affect the configuration data stored in RAM (DRIVE and VERIFY lists, drive and delay times, etc).

The [IP] or [Instr Preset] key does a *RST operation, as does the *TST? command.

Example Command

```
OUTPUT 709; "*RST"
```

***SRE (Request Enable)**

Syntax

*SRE mask

*SRE?

Description

The *SRE command sets the Service Request Enable Register bits. This will indicate whether or not the device has at least one reason for requesting service. A one in the Service Request Enable Register will enable the corresponding bit in the Status Byte Register; a zero will disable the bit.

Refer to the table below for the bits in the Service Request Enable Register and what they mask. Legal number range is 0 to 255.

- At power up the SRE register is 0.
- The *SRE query returns the current value.

Table 6-4 Service Request Enable Register

Bit	Weight	Enables
7	128	SCPI Operation Summary Bit
6	64	RQS - Request Service
5	32	ESR - Event Status Register
4	16	MAV - Message Available
3	8	SCPI Questionable Summary Bit
2	4	Not used
1	2	Not used
0	1	Not used

*STB (Status Byte)

Syntax

*STB?

Description

The *STB query returns the current value of the instrument's status byte. Refer to the table below for the definitions of the bits in the status byte.

Table 6-5 *Status Byte Bit Definitions*

Bit	Weight	Name	Condition
7	128	OPER	0 = no operation status events have occurred 1 = an operation status events has occurred
6	64	RQS/MSS	0 = instrument has no reason for service 1 = instrument is requesting service
5	32	ESR	0 = no event status events have occurred 1 = an enabled event status condition has occurred
4	16	MAV	0 = no output messages are ready 1 = an output message is ready
3	8	QUES	0 = no questionable conditions have occurred 1 = a questionable condition has occurred
2	4	___	always 0
1	2	___	always 0
0	1	___	always 0

Example Query

```
OUTPUT 709;"*STB?"  
ENTER 709;Value  
PRINT Value
```

Refer to the STATUS command in the “SCPI Command Reference” in this chapter for more information on the OPERATION register and summary bit.

***TST? (Test)**

Syntax

*TST?

Description

*TST? causes all relays to cycle through both of their positions (first all the CLOSE paths are set; then all the OPEN paths), and then get placed in the appropriate power up positions. Refer to *RST.

All relays for which sensing is enabled (VERIFY:ON) are checked for proper operation each time they are switched. Unused relays (DRIVE:OFF) are neither switched nor checked.

The result of the test will be placed in the output queue. A 0 indicates that the test passed and a non-zero value indicates the test failed.

Example Query

```
OUTPUT 709;"*TST?"  
ENTER 709;Result  
PRINT Result
```

***WAI**

Syntax

*WAI

Description

The *WAI command causes the instrument to wait for all pending HP-IB operations to finish before processing any further commands.

Example

OUTPUT 709; " *WAI "

Hierarchy

Table 6-6 Command Tree

ROUTE			
	:CLOSE		
	:OPEN		
	:PATH		
		:DEFine	
		:CATalog	
		:LABel	
		:VALue	
		:DELete	:ALL
	:GROUP		
		:NAME	
		:CATalog	
		:ADD	
		:REMOve	
		:DEFine?	
		:LABel	
		:AUTOselect	
			:ON
			:OFF
		:DELete	
		:DELete	:ALL

Remote Operation
Hierarchy

Table 6-6. Command Tree (continued)

ROUTE			
	:PFail		
		:CLOSE	
		:OPEN	
		:DELeTe	
	:VERify		
		:ON	
		:OFF	
			:ALL
	:DRIVe		
		:ON	
		:OFF	
			:ALL
	:WIDth		
	:DELay		
DIAGnostics			
	:SERialnumber[?]		
	:MODElnumber[?]		
	:EEROM		
		:CYCles?	

Table 6-6. Command Tree (continued)

MEMory		
	:DELeTe	
	:INITialize	
	:SAVE	
	:FREE?	
STATus		
	:OPERation	
		: [EVENT]?
		: CONDition?
		: ENABLe[?]
		: PTRansition
		: NTRansition
	: QUEStionable	
		: [EVENT]?
		: CONDition?
		: ENABLe[?]
SYSTem		
	: VERsion?	
	: ERRor?	
TRIGger		
	: SEQuence	
		: DELay[?]

SCPI Command Reference

Channel Lists

The HP 87130A can control up to seven different external driver cards, each of which can drive up to 31 different relays. The cards are numbered from 1 to 8; the relays on each card are numbered from 0 to 30. Each relay is referred to as a *channel* by the switch driver. Therefore, there are a total of 248 relays (channels) that can be driven from a single switch driver.

In order to realize the capability of the switch driver, many of the commands listed in the “SCPI Command Reference” utilize a language construct called a channel list. A single remote command may specify single or multiple relays by means of this channel list.

The syntax for channel lists is as follows:

```
(@channel number, channel number, ...,)
```

or

```
(@channel number: channel number,),(a range)
```

or

```
(@card number, (channel number, channel number, ...,))
```

or

```
(@card number, (channel number: channel number,))
```

or

```
(@) empty channel list
```

The card number must always be sent, either as the card number parameter or as part of a channel number (or range). When sent as part of a channel number, the card number is multiplied by 100 and added to the channel number. For example, 214 would mean channel 14 on card 2.

Example

```
(@101,2(0:5),3(1,3,5),406:410)
```

This means channel 1 on card 1, channels 0 through 5 on card 2, channels 1, 3 and 5 on card 3, and channels 6 through 10 on card 4.

SCPI Commands

The following pages list all of the SCPI compound command program mnemonics used to program this instrument.

:ADD

Syntax

```
ROUTE:GROUP:ADD <group name>, <path name>
```

Description

This command adds an existing path to the end of an existing group. The group name and path name must have been previously defined using `GROUP:NAME` and `PATH:DEF`. A path may be added to a group in several places by issuing this command several times. Only one path can be added for each issuance of `ADD`.

Example Command

```
ROUTE:GROUP:ADD ATTEN,ATTEN_14;
```

A previously defined path `ATTEN_14` is added to group `ATTEN`. Refer to the query `:DEFine? <group name>` to list all paths in a group.

:AUTOselect

Syntax

```
ROUTE:GROUP:AUTOselect[?] { [ :ON ] } <group name>
                             [ :OFF ] }
```

Description

This turns the current Auto Select state for the group on or off.

Example Command

```
ROUTE:GROUP:AUTO:ON ATTEN;
```

This turns the current Auto Select state for the group ATTEN on.

```
ROUTE:GROUP:AUTO:OFF ATTEN;
```

This turns the current Auto Select state for the group ATTEN off.

Example Query

```
ROUTE:GROUP:AUTO? ATTEN;
```

or

```
ROUTE:GROUP:AUTO:ON? ATTEN;
```

This queries the current autoselect state for the group. If the current state of autoselect for group ATTEN is ON, a 1 will be returned.

```
ROUTE:GROUP:AUTO:OFF? ATTEN;
```

If the current state of autoselect for group ATTEN is OFF, a 1 will be returned.

:CATalog?

Syntax

$$\text{ROUTE} \left\{ \begin{array}{l} \text{:PATH} \\ \text{:GROUP} \end{array} \right\} \text{:CATALOG?}$$

Description

Returns a list of groups (up to 16) *or* all defined paths in the module.

Example Query

```
ROUTE:GROUP:CATALOG?
```

This query returns a list of all of the group names, in order from 1 to 16, separated by commas.

```
ROUTE:PATH:CATALOG?
```

This query returns a list of all the defined paths in the module, separated by commas.

:CLOSE

Syntax

```
ROUTE:CLOSE[?] {<path name>
                {<channel list>}}

ROUTE:PFail:CLOSE[?] {<path name>
                     {<channel list>}}
```

Description

Each channel has a CLOSE or OPEN position. On Hewlett-Packard relays, the CLOSE path is the path between the input terminal labeled 2 on the relay and the input terminal labeled C. It is recognized that CLOSE and OPEN are arbitrary for this type of switch; they are, however, in keeping with the SCPI language specification.

Example Command

```
ROUTE:CLOSE (@101,2(0:5),3(1,3,5),406:410);
```

Sending the above command causes channel 1 on card 1, channels 0 through 5 on card 2, channels 1, 3 and 5 on card 3, and channels 6 through 10 on card 4 to be closed.

- Channels must have `DRIVE:ON` to be closed or they will be ignored.
- During any switching operation (OPEN or CLOSE) the settling bit in the OPER status register is set (1). It is cleared (0) when the operation completes.

Example Query

```
ROUTE:CLOSE? (@101,103,105);
```

Sending the query (question mark) causes the channels in the channel list parameter to be checked for closed channels. The readback is a list of 1's and 0's separated by commas, one for each channel in the list. A 1 is sent if the specified channel is closed; otherwise a 0 is sent.

Devices for which sensing is on (`VERIFY:ON`) read back the position in which they were sensed the last time a switching operation took place.

Devices with sensing off simply read back the currently programmed state (which, if they haven't been switched since power up, will be the state they were set to at power up). Devices with `DRIVE:OFF` read back the last value to which they were set.

Example Command

```
ROUTE:CLOSE ATTEN_14;
```

Sending the above command causes the set of switch OPENs and CLOSEs defined by the PATH (refer to PATH in this section) with name ATTEN_14 to be executed. The first group of switch settings in the PATH is interpreted as CLOSE settings and the second group as OPEN settings. The XA OSE settings are all executed first, followed by the OPEN settings.

Example

If ATTEN_14 had been defined as:

```
ROUTE:PATH:DEF ATTEN_14, (@101,102), (@103,104);
```

when that path is sent by ROUTE:CLOSE ATTEN_14, switches 101 and 102 will first be closed, and then switches 103 and 104 will be opened.

The query form is not available when using a path name, due to the potential for confusion between the first and second groups in the path.

NOTE

If you are configuring hardware for switching systems, keep in mind that CLOSE settings are executed before OPEN settings when a path is sent.

For example, multistage attenuators should be set up so that a CLOSE operation always adds attenuation and an OPEN operation removes attenuation. This ensures that in moving from one attenuation setting to another, the intermediate stage (after the CLOSEs and before the OPENs) is a stage representing higher attenuation and thus avoids signal spikes that could damage sensitive hardware.

Example Command

```
ROUTE:PFAIL:CLOSE (@101,2(0:5),3(1,3,5));
```

The ROUTE:PFAIL:CLOSE command lists the channels desired to be closed on power up or after *RST or *TST?. The channel list has the same restrictions as those for the ROUTE:CLOSE command. Sending the command in the example above causes channel 1 on card 1, channels 0 through 5 on card 2, and channels 1, 3 and 5 on card 3 to be closed on power up.

```
ROUTE:PFAIL:CLOSE ATTEN_14;
```

Sending the above command causes the set of switch OPENs and CLOSEs defined by the PATH with name ATTEN_14 to be added to the PFAIL list. The first group of switch settings in the PATH is interpreted as CLOSE settings and the second group as OPEN settings.

Example Query

```
ROUTE:PFAIL:CLOSE? (@101,205);
```

The inclusion of a question mark causes a readback of the power up state of the requested channels as a list of 1's and 0's separated by commas. A 1 means the channel is in the PFA:CLOS list. A 0 means that it is not.

Remote Operation

:CLOSe

- When querying the `PFAil` state, the `PFA:OPEN` list must be checked as well to determine whether the power up state for a given channel is programmed at all.
- If a relay is not in the `PFAil:OPEN` list or the `PFAil:CLOSe` list, its power up state is determined by the last save stored to EEROM for that relay.

:CYCLes?

Syntax

```
DIAGnostics:EERom:CYCLes?
```

Description

This query causes the HP 87130A to read back the number of times to which the EEROM has been written. If this number exceeds 10,000 the EEROM should be replaced. If the EEROM has never been written to, then 0 is returned.

Example Command

```
DIAG:EEROM:CYCLES?
```

:DEFine

Syntax

```
ROUTE:PATH:DEFine <path name>,<channel list> [,<channel list>]
```

```
ROUTE:GROUP:DEFine? <group name>
```

```
ROUTE:PATH:DEFine? <path name>
```

Description

Under the `PATH` subsystem, this command is used to define or redefine the switch settings that make up a path.

- This command effectively “creates” a path by assigning the path name to one of the 256 internal path registers (if no register is available, a memory error will be declared). No other command referencing that path name may be sent before the `DEFine` command is sent.
- A path name is any collection of up to 12 uppercase letters (lowercase letters are automatically uppercased), numbers, or underscore characters, starting with a letter.
- If the path name already exists, the old settings (both `CLOSE` and `OPEN`) will be erased and the new settings established from the new channel list.
- The channel lists used by `PATH:DEF` follow all the normal rules for channel lists, and may contain any combination of switches from one or more driver cards. The second channel list is optional; if not sent it will be treated as empty. The empty channel list (`@`) may be sent for either parameter.
- If a channel is included in both of the channel lists in a path, no error is declared, but the channel will be removed from the first list and only retained in the second.
- The interpretation of the data in a path depends on how it is used. If sent using `ROUTE:CLOSE <path name>` or by the manual interface, the first channel list is a `CLOSE` list and the second an `OPEN` list. If sent using `ROUTE:OPEN <path name>`, the first channel list is an `OPEN` list and the second a `CLOSE` list.

Example Command

```
ROUTE:PATH:DEF ATTEN_14,(@101,2(0:5)),(@102);
```

This command defines a path whose name is `ATTEN_14` whose first channel list affects channel 1 on card 1 and channels 0 through 5 on card 2, and whose second channel list affects channel 2 on card 1.

Example Query

```
ROUTE:PATH:DEFine? ATTEN_14;
```

The query form returns a path description as two channel lists separated by a comma. It can be sent back by appending it to a `PATH:DEF` command to recreate the path. For the example command above, the response should look like:

```
(@101,2(0:5)),(@102)
```

Example Query

```
ROUTE:GROUP:DEF? ATTEN;
```

This query returns a list of all of the path names in the group `ATTEN`, in order, separated by commas.

:DElay

Syntax

$$\text{ROUTE:DElay:} \langle \text{delay time} \rangle, \left\{ \begin{array}{l} \langle \text{channel} \rangle \\ \langle \text{path name} \rangle \end{array} \right\}$$

This commands sets the delay time in seconds required to validate the sense lines on a relay for which sensing will be used. The drive signal will be held on the relay for this amount of time after the pulse width requirement (refer to “:WIDTh”) has been satisfied.

The delay time may be set in 5 ms increments up to 1275 ms. The delay time defaults to 20 ms when memory is initialized. The delay parameter may be an integer or real number.

NOTE

The :DElete and the :DElay shortform is the same. The :DElete command applies only in syntax with other subsystems and not directly to channel lists.

Example Command

```
ROUTE:DELAY .02,(@101,103,105);
OUT:DEL 20ms,(@101,103,105);
```

In the above example, the delay time is set to 20 ms for channels 1, 3, and 5.

```
ROUTE:DELAY .02,ATTEN_14;
```

This command causes the drive to the set of relays (defined by the ROUTE:PATH command) with path name ATTEN_14 to be set to 20 ms. If the path includes two channel lists, all relays in both list are affected.

Example Query

```
ROUTE:DELAY? (@101,103,105);
```

In this case, the sense delay for channels 101, 103 and 105 is read back, with the values separated by commas. For example, if all three are set to 20 ms, then the readback is:

```
+2.000E-02,+2.000E-02,+2.000E-02
```

NOTE

The query form is not available when using a path name due to the potential for confusion between the first group and the second in the path.

:DELeTe

Syntax

$$\text{ROUTE} \left\{ \begin{array}{l} \text{:PATH} \\ \text{:GROUP} \end{array} \right\} \text{:DELeTe} \left\{ \begin{array}{l} \langle \text{path name} \rangle \\ \langle \text{group name} \rangle \\ [\text{:ALL}] \end{array} \right\}$$

Description

This command deletes :

- All data associated with the specified path or group and frees up the path storage register.
- All channels from the PFAIL list.

This command sets memory to an initial state.

NOTE

The :DELeTe and the :DELaY shortform is the same. The :DELeTe command applies only in syntax with other subsystems and not directly to channel lists from ROUTe.

Example Command

- ROUTE:PATH:DELETE ATTEN_14;

This deletes the path with pathname ATTEN_14 and all data in it.

- ROUTE:PATH:DELETE:ALL;

This deletes all paths.

- ROUTE:GROUP:DEL ATTEN;

This deletes all data associated with the group ATTEN. The group name is set to the default (refer to MEM:DELETE).

- ROUTE:GROUP:DEL:ALL;

This deletes all data associated with all the groups. The group names are set to the default (refer to MEM:DELETE).

- ROUTe:PFAil:DELeTe;

This command removes all data from the PFAIL:OPEN and PFAIL:CLOSE lists.

- MEMoRY:DELeTe;

:DElete

MEMory:DElete erases all data from CMOS RAM, by filling it with zeroes, and then sets it to an initial state. That state is as follows:

- The power fail channel lists are empty (ROUT:PFA:CLOS and ROUT:PFA:OPEN).
- Sensing (VERIFY) is OFF for all devices.
- The ROUT:DRIVE:ON list has channels 0 through 30 on card 1 used and all other channels unused.
- The WIDTH is set to 30 ms pulse width; DELAY is set to 20 ms for all 256 devices.
- The group names are defaulted to GROUP1, GROUP2, and so on through GROUP16.
- The path VALues are defaulted to the path register number, 1–256.
- The GROUP and PATH registers are empty.

If you also wish to delete the EEROM data, this command should be followed by a MEM:SAVE command to copy this state to the EEROM.

This command does not affect the “last switch state” area in the RAM image, even though there is a “last switch state” stored in the EEROM, because the last state must always match the actual last state of the switches. Nor does it affect the model number and serial number.

:DRIVE

Syntax

$$\text{ROUTE:DRIVE} \left\{ \begin{array}{l} [:ON] \\ :OFF \end{array} \right\} : \text{ALL}$$

$$\text{ROUTE:DRIVE} \left\{ \begin{array}{l} [:ON] \\ :OFF \end{array} \right\} [?] <\text{channel list}>$$

$$\text{ROUTE:DRIVE} \left\{ \begin{array}{l} [:ON] \\ :OFF \end{array} \right\} : <\text{pathname}>$$

Description

There is a list of relays considered unused or “not there” by the firmware. Unused channels are not driven even if included in a channel list or path and are not checked for proper sense line state and cannot generate errors. Turning :DRIVE:OFF for a channel adds it to the Unused List.

NOTE

In systems without CMOS RAM it is necessary to execute a write to EEROM to ensure that the :DRIVE data will survive a power cycle. Refer to the MEM:SAVE command.

Example Command

- ROUTE:DRIVE:ON (@101,103,105);

This command removes channels 1, 3, and 5 on card 1 from the Unused List.

- ROUTE:DRIVE:OFF (@101,103,105);

This command adds channels 1, 3, and 5 on card 1 to the Unused List.

- ROUTE:DRIVE:OFF ATTEN_14;

This command causes the set of relays (defined by the ROUTE:PATH command) with name ATTEN_14 to be added to Unused List.

If the path includes two channel lists, all relays in both lists are affected.

- ROUTE:DRIVE:ON:ALL;

This turns drive on for all channels.

- ROUTE:DRIVE:OFF:ALL;

Drive is turned off for all channels; that is, all channels are “unused”.

Example Query

- `ROUTE:DRIVE:ON? (@101,103,105);`

This command returns a list of 1's and 0's, separated by commas, depending on whether drive is on or off for the indicated channels.

If it is on for channels 101 and 105 and off for 103, the switch driver will return:

`1,0,1`

- `ROUTE:DRIVE:OFF? (@101,103,105)`

This command returns a list of 1's and 0's, separated by commas, depending on whether drive is on or off for the indicated channels.

If it is on for channels 101 and 105 and off for 103, the switch driver will return:

`0,1,0`

The query form is not available when using a path name, due to the potential for confusion between the first group and the second in the path.

:EERom

Syntax

DIAGnostics:EERom:CYCLes?

Description

This function allows EERom information to be read out. (Refer to :CYCLes.)

:ERRor?

Syntax

SYSTem:ERRor?

Description

As SCPI specifies, this reads out the full error number and error description for the first error in the error queue. It can be issued repeatedly until the queue is empty (indicated by 0, "No error").

All possible error numbers with their descriptions are listed below.

Command Errors

These set the Cmd Err bit in ESR.

- 100,Command error
- 100,Command error;SCPI unused invalid character
- 101,Invalid character;bad type Syntax error
- 103,Invalid separator
- 104,Data type error
- 105,GET not allowed
- 108,Parameter not allowed
- 108,Parameter not allowed;invalid
- 109,Missing parameter
- 112,Program mnemonic too long
- 113,Undefined header
- 121,Invalid character in number
- 123,Exponent too large
- 124,Too many digits
- 128,Numeric data not allowed
- 131,Invalid suffix
- 138,Suffix not allowed
- 141,Invalid character data
- 148,Character data not allowed
- 150,String data error
- 151,Invalid string data
- 158,String data not allowed
- 161,Invalid block data
- 168,Block data not allowed
- 170,Expression error;too long
- 171,Invalid expression
- 178,Expression data not allowed

- 181,Invalid outside macro definition
- 183,Invalid inside macro definition

Execution Errors

These set the Exec Err bit in ESR.

- 200,Execution error
- 222,Data out of range
- 223,Too much data
- 270,Macro error
- 272,Macro execution error
- 273,Illegal macro label
- 276,Macro recursion error
- 277,Macro redefinition not allowed

Device Specific Errors

These set the Cmd Err bit in ESR.

- 310,System error
- 310,System error;SCPI internal
- 310,System error;no memory
- 310,System error;formatter
- 777,Queue Overflow

1001,Sense error;<17 hex digits>

This error is generated when an apparently impossible state of the sense lines from one or more relays is detected. The first of the 17 hex digits represents the card number on which the failure was detected; the rest represent a 64-bit binary number which indicates which of the 32-channels experienced failures.

Each channel has two associated bits; the leftmost indicates that the error was detected on the CLOSeD side of the relay; the rightmost that the error was detected on the OPEN side. A failure is indicated with a 1. The least significant (rightmost) two bits are channel 0, the most significant (leftmost) are channel 31. If more than one card experiences failures then more than one error will be reported.

1002,Memory capacity exceeded

An attempt has been made to store more data than will fit in the 16 Kbyte nonvolatile memory area.

1003,Timer unstable

Instability has been detected in the 6840 timer chip, so the operating system cannot run reliably.

:ERRor?

1004,EEROM data invalid

Corruption has been detected in the EEROM; it needs to be replaced, or, if brand new, it needs to have `MEM:SAVE` executed once.

1006,Channel timeout <17 hex digits>

This error is generated when a relay apparently fails to switch, based on the detected state of the sense lines. The 17 hex digits indicate which card and which of the 32 channels experienced failures just as for error 1001. Each channel has two associated bits; the leftmost indicates that the error was detected on the CLOSED side of the relay; the rightmost that the error was detected on the OPEN side. A failure is indicated with a 1.

- A **Channel timeout** without an accompanying **Sense error** indicates that the sense lines were in a valid state, but it was the wrong state.
- A **Channel timeout** with a **Sense error** indicates that both sense lines appeared to be at 0 V.
- A **Sense error** without a **Channel timeout** means both sense lines appeared to be at 24 V.

1007,Label too long

A path or group label was more than 32 characters long.

1008,Nonexistent group

An attempt was made to use a group name which was not previously set up with a `GROUP:NAME` command.

1009,Group already exists

An attempt was made to name a group with a name already in use by another group.

1010,Nonexistent path

An attempt was made to use a path name which was not previously set up with a `PATH:DEF` command.

4000,Divide by Zero

4001,Float Overflow

4002,Float Underflow

4003,Logarithm Error

4004,Integer Overflow

4005,Square Root Error

Query Errors

These set the Query Err bit in ESR.

-400,Query error

-410,Query INTERRUPTED

-420,Query UNTERMINATD

-430,Query DEADLOCKED

:FREE?

Syntax

MEMory:Free?

Description

This is a query which returns the number of bytes that remain in RAM for storing configuration data, followed by the number of bytes initially available. The two quantities are separated by commas. For a brand new system there are around 13,000 bytes initially available.

The group names and titles, power fail, verify and drive lists, and device switching times are saved in a fixed size area of memory, and available RAM is unaffected by changing this data.

For the rest of the data, it is allocated as needed. For any given PATH, one or more of the eight cards in the HP 87130A will be represented. It takes nine bytes to store the complete state of a card and only those cards actually referenced in a given path are saved.

Path titles take up the number of characters in title, and path names take up the number of characters in the name. Every path added to a group takes up one byte. It is up to the user to allocate this memory as appropriate; for example, if a lot of path data is going to be used, path names and titles can be kept short to conserve space.

:GROUP

Syntax

```
ROUTE: GROUP: {
    :NAME
    :CATALOG?
    :ADD[?]
    :REMOVE[?]
    :DEFine[?]
    :LABEL[?]
    :AUTOselect[?]
    :DELete[:ALL]
}
```

Description

The `GROUP` subsystem allows grouping of paths to customize the manual interface to the HP 87130A.

A “group” is an ordered collection of up to 256 paths. Paths can be collected into meaningful groups using the `GROUP` command. The HP 87130A can store up to 16 groups. Each group may be defined and labeled.

NOTE

In systems without CMOS RAM it is necessary to execute a write to EEROM after configuring custom groups to ensure that the group data will survive a power cycle. Refer to the `MEM:SAVE` command.

:INITialize

Syntax

MEMory:INITialize

Description

When this command is issued, RAM is initialized according to the following algorithm:

1. RAM is initialized to the state described in MEMory:DELete. This command essentially erases any changes that have been made to RAM since the last power cycle.
2. The model number is initialized to HP 87130A. The serial number is initialized to USXXXXXXXX.

When equipment is manufactured by Hewlett-Packard, it is given a unique serial number. A serial number label is attached to the rear panel of the module. The first six entries are the same for all identical modules; they only change when a change in the electrical or physical functionality is made. The remaining digits are assigned sequentially and are different for each instrument.

3. If the EEROM is not defective, its data is downloaded into RAM, which cancels the effect of steps 1 and 2. If the EEROM is faulty, no download is performed.

This initialization algorithm is the same algorithm used at power up to initialize RAM, except that at power up, before step three is performed, the “last state” in RAM is set to all relays OPEN. Hence, in the case of a failed EEROM, “last state” defaults to all relays OPEN.

:LAbel[?]

Syntax

```
ROUTE { :PATH } :LAbEL { <path name> } "<label>";
      { :GROUP }
```

Description

This command specifies a label (32 characters max) to be used when labeling the group on manual interface screens. Any character may be used within the quotes as long as its value is between 32 and 127. These values are treated as ASCII characters.

Example Command

```
ROUTE:PATH:LAbEL ATTEN_14, "14 dB ATTEN";
```

The above commands assigns the label 14 dB ATTEN to the previously defined path with the pathname ATTEN_14.

Example Query

```
:LAbel? <path name>
```

```
ROUTE:PATH:LAbEL? ATTEN_14;
```

The query form returns the programmed label:

```
14 dB ATTEN
```

Example Command

```
ROUTE:GROUP:LAbEL ATTEN, "Attenuation";
```

The above commands assigns the label Attenuation to the group with the group name ATTEN.

Example Query

```
:LAbel? <group name>
```

```
ROUTE:GROUP:LAbEL? ATTEN;
```

The query form returns the programmed label:

```
Attenuation
```

MEMory

Syntax

	}	
MEMory		:DELeTe
		:INITialize
		:SAVE
	:FREE?	}

Description

The MEMory subsystem is used to delete, initialize RAM, and save EEROM information to the controller.

:NAME**Syntax**

```
ROUTE:GROUP:NAME <number>,<group name>
```

Description

The groups are numbered from 1 to 16. They may be named or renamed using this command. An attempt to name a group using a name already in use for another group will result in an error.

A group name is any collection of up to 12 uppercase letters (lowercase letters are automatically uppercased), numbers, or underscore characters, starting with a letter.

Refer to the `MEM:DELETE` command description for the default group names assigned when memory is initialized or a group is deleted.

Example Command

```
ROUTE:GROUP:NAME 1,ATTEN;
```

This command associates the name `ATTEN` with group 1 for programming purposes.

:OPEN

Syntax

```
ROUTE:OPEN[?] { <path name> }  
                { <channel list> }
```

```
ROUTE:PFail:OPEN[?] { <path name> }  
                    { <channel list> }
```

Description

Each channel has a CLOSE or OPEN position. On Hewlett-Packard relays, the OPEN path is the path between the input terminal labeled 1 on the relay and the input terminal labeled C. It is recognized that CLOSE and OPEN are arbitrary for this type of switch; they are, however, in keeping with the SCPI language specification.

Example Command

```
ROUTE:OPEN (@101,2(0:5),3(1,3,5),406:410);
```

During any switching operation (OPEN or CLOSE) the settling bit in the OPER status register is set (1). It is cleared (0) when the operation completes.

Sending the above command causes channel 1 on card 1, channels 0 through 5 on card 2, channels 1, 3 and 5 on card 3, and channels 6 through 10 on card 4 to be opened. Channels must be part of the drive list (DRIVE:ON) to be opened or they will be ignored.

Example Query

```
ROUTE:OPEN? (@101,103,105);
```

Sending the query (optional question mark) causes the channels in the channel list parameter to be checked for opened channels. The readback is a list of 1's and 0's separated by commas, one for each channel in the list. A 1 is sent if the specified channel is opened, otherwise a 0 is sent. Although this command is not strictly necessary (ROUTE:CLOSE? is sufficient), it is included for completeness.

Devices for which sensing is on, read back the position in which they were sensed the last time a switching operation took place. Devices with sensing off simply read back the currently programmed state (which will be the state they were set to at power up if they haven't been switched since power up). Devices with DRIVE:OFF read back the last value to which they were set.

Remote Operation

:OPEN

It is possible to combine `OPEN` and `CLOSE` in a single command since they are both part of the `ROUTE` subsystem. For example:

```
ROUTE:CLOSE (@406:410);OPEN (@202);
```

This command will close channels 6 through 10 on card 4 and open channel 2 on card 2.

Example Command

```
ROUTE:OPEN ATTEN_14;
```

Sending the above command causes the set of switch `OPEN`s and `CLOSE`s defined by the `PATH` with name `ATTEN_14` to be executed. The first group of switch settings in the `PATH` is interpreted as `OPEN` settings and the second group as `CLOSE` settings.

The `CLOSE` settings are all executed first, followed by the `OPEN` settings.

For example, if `ATTEN` had been defined as:

```
ROUTE:PATH:DEF ATTEN_14, (@101,102), (@103,104);
```

then when that path is sent by `ROUTE:OPEN ATTEN_14`, switches 103 and 104 will first be closed and then switches 101 and 102 will be opened.

NOTE

If you are configuring hardware for switching systems, keep in mind that `CLOSE` settings are executed before `OPEN` settings when a path is sent.

For example, multistage attenuators should be set up so that a `CLOSE` operation always adds attenuation and an `OPEN` operation removes attenuation. This ensures that in moving from one attenuation setting to another, the intermediate stage (after the `CLOSE`s and before the `OPEN`s) is a stage representing higher attenuation, and thus avoids signal spikes that could damage sensitive hardware.

Example Command

```
ROUTE:PFail:OPEN (@101,2(0:5),3(1,3,5));
```

The `ROUTE:PFail:OPEN` command lists the channels desired to be opened on power up or after `*RST` or `*TST?`. The channel list has the same restrictions as those for the `ROUTE:OPEN` command. Sending the command in the example above causes channel 1 on card 1, channels 0 through 5 on card 2, and channels 1, 3 and 5 on card 3 to be opened on power up.

```
ROUTE:PFail:OPEN ATTEN_14;
```

Sending the above command causes the set of switch `OPEN`s and `CLOSE`s defined by the `PATH` with name `ATTEN_14` to be added to the `PFAIL` list.

The first group of switch settings in the `PATH` is interpreted as `OPEN` settings and the second group as `CLOSE` settings.

Example Query

```
ROUTE:PFai1:OPEN? (@101,205);
```

The inclusion of a question mark causes a readback of the power up state of the requested channels as a list of 1s and 0s separated by commas.

- A 1 means the channel is in the PFA:OPEN list.
- A 0 means that it is not.

When querying the PFAIL state, the PFA:CLOS list must be checked as well to determine whether the power up state for a given channel is programmed at all.

If a relay is in neither the PFAi1:OPEN or PFAi1:CLOS lists, its power up state is determined by the last save stored to EEROM for that relay.

The query form is not available when using a path name, due to the potential for confusion between the first group and the second in the path.

:PATH

Syntax

```
ROUTE:PATH { :DEFine[?]
             :CATalog?
             :LABel[?]
             :VALue[?]
             :DELete[:ALL] }
```

Description

The `PATH` subsystem allows storing of channel lists to simplify remote access and to customize the manual interface to the HP 87130A.

- Paths are specified using `CLOSE` and `OPEN` channel lists. Each relay contains one `CLOSE` and one `OPEN` path. Refer to the `:CLOSE` and `:OPEN` command explanations for more information.
- A path is defined as a specification of switch positions for a range of switches. Thus it may require one or two channel lists to fully specify a path, depending on the mix of `OPEN`s and `CLOSE`s in the path.
- The paths can be defined, labeled, and/or sent to the hardware. Each path has a name by which it is referenced for the purpose of programming, which is established by the `PATH:DEF` command.
- The paths can be collected into meaningful groups using the `GROUP` command. They can also be sent in place of channel lists by the `ROUTE` and other commands.

NOTE

In systems without CMOS RAM it is necessary to execute a write to EEROM after configuring custom paths to ensure that the path data will survive a power cycle. Refer to the `MEM:SAVE` command section.

:PFAil

Syntax

$$\text{ROUTE:PFAil} \left\{ \begin{array}{l} \text{:CLOSe} \\ \text{:OPEN} \\ \text{:DELete} \end{array} \right\} \left\{ \begin{array}{l} \langle \text{path name} \rangle \\ \langle \text{channel list} \rangle \end{array} \right\}$$

Description

The ROUTE:PFAil subsystem of SCPI allows specification of which channels will be closed on a power cycle (or *RST or *TST?).

- Channels not specified by ROUTE:PFAIL:CLOSE or ROUTE:PFAIL:OPEN are set during power up by reading the last switch state out of EEROM or CMOS RAM, or if the EEROM data is corrupt, by OPENing the channel.
- Channels not on the drive list (DRIVE:OFF) are not affected at power up even if in the PFAIL list.

NOTE

In systems without CMOS RAM it is necessary to execute a write to EEROM to ensure that the PFAIL lists will survive a power cycle. Refer to the MEM:SAVE command section.

:REMove

Syntax

```
ROUTE:GROUP:REMove <group name>,<path name>
```

Description

This command removes all instances of the specified path from a group. The group name and path name must have been previously defined using `GROUP:NAME` and `PATH:DEF`.

Example Command

```
ROUTE:GROUP:REMOVE ATTEN,ATTEN_14;
```

Removes all paths named `ATTEN_14` from group `ATTEN`. Refer to the query `:DEFine? <group name>` to list all paths in a group.

ROUTE

Syntax

Refer to the command tree.

Description

Relay switching and configuration is accomplished by the `ROUTE` command tree.

:SAVE

Syntax

MEMory:SAVE

Description

This command copies the RAM image to the EEROM. Care should be taken to do this only when necessary, due to the limited life of the EEROM. (Refer to `DIAG:EEROM:CYCLES?`). Because this is time consuming (over a minute in some cases), it is made to turn on the “switching” light while saving. The CALIBRATING bit in the OPER status register is set when a save begins and cleared when it ends. *OPC can also be used to detect the end of a save.

The following data will be saved:

- the VERIFY list
- the DRIVE list
- the PFAIL list
- the serial number and model number
- the WIDTH and DELAY times for all switches
- all GROUP data, including group names, titles, AUTOSELECT state,
- what PATHs are in each group
- all PATH data, including path names, titles, and values
- what channels are in each PATH

In addition, in the “last state” list will be saved:

- the current state of all switches in the DRIVE list
- the programmed state of all switches NOT in the DRIVE list

If you know that you have performed a valid `SAVE` to the EEROM (one that was not interrupted by turning OFF power and which did not generate an error), and you subsequently get an `EEROM invalid` error message, you should replace the EEROM.

STATus

Syntax

$$\text{STATus:OPERation} \left\{ \begin{array}{l} :[\text{EVENT}]? \\ :[\text{CONDition}] \\ :[\text{ENABle}]? \\ :[\text{PTRansition}] \\ :[\text{NTRansition}]? \end{array} \right\}$$

$$\text{STATus:QUEStionable} \left\{ \begin{array}{l} :[\text{EVENT}]? \\ :[\text{CONDition}]? \\ :[\text{ENABle}]? \end{array} \right\}$$

Description

The STATus subsystem is fully specified by SCPI. Refer to the following commands: *STB?, *SRE, *ESE, and *ESR?

- STATus:OPERation

In the STATus:OPERation subsystem, only the settling bit (bit 1) is implemented by the HP 87130A; it is set during a switching operation (and when saving to EEROM) and cleared when it completes. The “SWITCHING” LED is on whenever this bit is set. The following commands are applicable:

- STATus:OPERation:EVENT
- STATus:OPERation:CONDITION?
- STATus:OPERation:ENABle
- STATus:OPERation:PTRansition[?]
- STATus:OPERation:NTRansition[?]
- STATus:OPERation:PTRansition[?]
- STATus:QUEStionable

The QUEStionable subsystem is required by SCPI but is not used by the HP 87130A, HP 70612A,C or HP 70613A,C. The following commands are implemented:

- STATus:QUEStionable:EVENT?
- STATus:QUEStionable:CONDition?
- STATus:QUEStionable:ENABle

SYSTEM

Syntax

SYSTEM { :VERSion?
:ERRor? }

Description

These are SYSTEM commands from the SCPI specification.

- VERSion?
- ERRor?

TRIGger

Syntax

```
TRIGger:SEQuence:DELAy <number>
```

Description

This command allows the user to control the 24 V power supply recovery time. Input values are limited to between 0 and 200 msec (200 msec is the default setting). The HB-IB command `TRIGger:SEQuence:DELAy` will allow entry of a new power recovery time. Values outside the 0 to 200 msec range will return an error.

Example Command

```
TRIG:SEQ:DEL .15
```

This example assigns the value, 150 msec, to the `TRIGger` command.

Example Query

```
TRIG:SEQ:DEL?
```

The query form returns the assigned number. For the example, it would return

```
.15
```

:VALue

Syntax

```
ROUTE:PATH:VALUE <path name>,<number>;
```

Description

This command specifies a number (integer in the range – 32768 to 32767) to be used when labeling the path on manual interface screens. This number, when entered manually from the user interface, can be used to select paths directly without using the RPG or step keys.

Example Command

```
ROUTE:PATH:VALUE ATTEN_14,14;
```

This example assigns a value of 14 to a path with pathname ATTEN_14.

Example Query

```
ROUTE:PATH:VALUE? ATTEN_14;
```

The query form returns the programmed number. For the example above, it would return

```
+14.
```

:VERify

Syntax

$$\text{ROUTE:VERify} \left\{ \begin{array}{l} \text{: [ON]} \\ \text{OFF} \end{array} \right\} \left\{ \begin{array}{l} \text{: ALL} \\ \text{<path name>} \\ \text{<channel list>} \end{array} \right\}$$
$$\text{ROUTE:VERify} \left\{ \begin{array}{l} \text{: [ON]} \\ \text{OFF} \end{array} \right\} [?] \text{<channel list>}$$

Description

This command adds or removes relays from the “sense list”, the list of relays for which sensing is enabled.

This command only works with relays that have the ability to sense the state of the switch. Refer to the list of Hewlett-Packard compatible switches and attenuators that have this capability.

NOTE

In systems without CMOS RAM it is necessary to execute a write to EEROM to ensure that the VERify data will survive a power cycle. Refer to the MEM:SAVE command.

Example Command

```
ROUTE:VERIFY:ON (@101,103,105);
```

This command adds channels 1, 3, and 5 on card 1 to the "sense list" . Due to the nature of sensing relays, enabling this sensing mode of operation may increase switching times, as the sense lines must settle after the switch is thrown. The default sensing delay is 20 ms. Refer to the :DELay command to adjust switching time when sensing is enabled.

With sensing on for a given switch, if that switch fails to switch, either on a ROUTE command or on *TST?, an error is generated. Furthermore, after any switching operation, all of the relays for which sensing is on (and for which DRIVE is also on) have their sense lines checked; erroneous values generate errors.

```
ROUTE:VERIFY:OFF (@101,103,105);
```

This command removes channels 1, 3, and 5 on card 1 from the "sense list" .

```
ROUTE:VERIFY:ON ATTEN_14;
```

This command causes the set of switches defined by the PATH with the pathname ATTEN_14 to be added to (ON) or removed from (OFF) the "sense

Remote Operation

:VERIFY

list. All switches referenced in either channel list in the path are added (ON) or removed (OFF).

```
ROUTE:VERIFY:OFF:ALL;
```

This turns sensing off for all channels.

Example Query

```
ROUTE:VERIFY:ON? (@101,103,105);
```

This command returns a list of 1's and 0's, separated by commas, depending on whether sensing is on or off for the indicated channels. For example if sensing is on for channels 101 and 105 and off for 103, the switch driver responds with:

```
1,0,1
```

```
ROUTE:VERIFY:OFF? (@101,103,105);
```

This command returns a list of 1's and 0's, separated by commas, depending on whether sensing is off or on for the indicated channels. For example, if it is on for channels 101 and 105 and off for 103, the switch driver responds with:

```
0,1,0
```

The query form is not available when using a path name, due to the potential for confusion between the first group and the second in the path.

:VERsion?

Syntax

SYSTem:VERsion?

Description

This reads out the firmware datecode.

:WIDTh

Syntax

```
ROUTE:WIDTh <pulse width>, { <channel list> }
                          { <path name> }
```

```
ROUTE:WIDTh <channel list>
```

Description

This command sets the pulse width in seconds required to close a relay. The pulse width may be set in 5 ms increments up to 1275 ms. The pulse width defaults to 30 ms when memory is initialized. The `WIDTh` parameter may be an integer or a real number.

Example Command

```
ROUTE:WIDTh .03,(@101,103,105);
```

In the above example, the pulse width is set to 30 ms for channels 1, 3, and 5.

```
ROUTE:WIDTh .03,ATTEN_14;
```

This command causes the drive with to the set of relays (defined by the `ROUTE:PATH` command) with path name `ATTEN_14` to be set to the specified pulse width. If the path includes two channel lists, all relays in both lists are affected.

Example Query

```
ROUTE:WIDTh? (@101,103,105);
```

In this case, the pulse width for channels 101, 103 and 105 is read back, with the values separated by commas. For example, if all three are set to 30 ms, then the readback is:

```
+3.000E-02,+3.000E-02,+3.000E-02
```

The query form is not available when using a path name, due to the potential for confusion between the first group and the second in the path.

Example Programs

The following programs written in HP Rocky Mountain Basic provide sample programs that may be helpful in programming the HP 87130A.

Save Memory

In order to use the following program, you must first create a file named SWDATA. The following program can be used to read configuration data out of the EEROM so that it can be replaced.

```
10    ! READMEM program. Takes data from HP 87130A and outputs
      to a file
20    DIM A$(32767)
30    DIM Serialnumber$(10),Modelnumber$(6)
40    DIM Groupnames$(15)[12],Grouptitles$(15)[32]
50    DIM Pathnames$(255)[12],Pathtitles$(255)[32],
      Pathval(255)
60    DIM Groupdata$(15,255)[12],Groupauto(15)
70    COM @Sw,@File
80    MAT Pathnames$= ("")
90    MAT Groupnames$= ("")
100   MAT Pathtitles$= ("")
110   MAT Grouptitles$= ("")
120   MAT Groupdata$= ("")
130   ASSIGN @File TO "SWDATA"
140   ASSIGN @Sw TO 709
150   Read_bitmap("ROUT:VERIFY:ON")
160   Read_bitmap("ROUT:DRIVE:ON")
170   Read_bitmap("ROUT:PFA:CLOS")
180   Read_bitmap("ROUT:PFA:OPEN")
190   OUTPUT @Sw;"DIAG:SER?"
200   ENTER @Sw;Serialnumber$
210   OUTPUT @File;Serialnumber$
220   OUTPUT @Sw;"DIAG:MOD?"
230   ENTER @Sw;Modelnumber$
240   OUTPUT @File;Modelnumber$
250   Read_bitmap("ROUT:WIDT")
260   Read_bitmap("ROUT:DELAY")
270   OUTPUT @Sw;"ROUTE:GROUP:CATALOG?"
```

Remote Operation

Example Programs

```
280  ENTER @Sw;A$
290  I=-1
300  WHILE LEN(A$)>0
310      Comma=POS(A$,"")
320      IF Comma=0 THEN
330          A$=A$&" "
340          Comma=LEN(A$)
350      END IF
360      I=I+1
370      Groupnames$(I)=A$[1;Comma-1]
380      A$=A$[Comma+1]
390  END WHILE
400  OUTPUT @File;Groupnames$(*)
410  Max_group=I
420  FOR G=0 TO Max_group
430      OUTPUT @Sw;"ROUT:GROUP:LABEL? "&Groupnames$(G)
440      ENTER @Sw;Grouptitles$(G)
450      OUTPUT @Sw;"ROUT:GROUP:AUTOSELECT:ON? "&Groupnames$(G)
460      ENTER @Sw;Groupauto(G)
470      OUTPUT @Sw;"ROUT:GROUP:DEF? "&Groupnames$(G)
480      ENTER @Sw;A$
490      I=-1
500      WHILE LEN(A$)>0
510          Comma=POS(A$,"")
520          IF Comma=0 THEN
530              A$=A$&" "
540              Comma=LEN(A$)
550          END IF
560          I=I+1
570          Groupdata$(G,I)=A$[1;Comma-1]
580          A$=A$[Comma+1]
590      END WHILE
600  NEXT G
610  OUTPUT @File;Groupdata$(*)
620  OUTPUT @File;Groupauto(*)
630  OUTPUT @File;Grouptitles$(*)
640  OUTPUT @Sw;"ROUTE:PATH:CATALOG?"
650  ENTER @Sw;A$
660  I=-1
```

```

670 WHILE LEN(A$)>0
680     Comma=POS(A$," , ")
690     IF Comma=0 THEN
700         A$=A$&" , "
710         Comma=LEN(A$)
720     END IF
730     I=I+1
740     Pathnames$(I)=A$[1;Comma-1]
750     A$=A$[Comma+1]
760 END WHILE
770 OUTPUT @File;Pathnames$(*)
780 Max_path=I
790 FOR P=0 TO Max_path
800     OUTPUT @Sw;"ROUT:PATH:LABEL? "&Pathnames$(P)
810     ENTER @Sw;Pathtitles$(P)
820     OUTPUT @Sw;"ROUT:PATH:VALUE? "&Pathnames$(P)
830     ENTER @Sw;Pathval(P)
840     OUTPUT @Sw;"ROUT:PATH:DEF? "&Pathnames$(P)
850     ENTER @Sw;A$
860     OUTPUT @File;A$
870     ! HAVE TO OUTPUT THIS DATA ON THE FLY, AS IT IS A
        POTENTIALLY HUGE ARRAY
880 NEXT P
890 OUTPUT @File;Pathtitles$(*)
900 OUTPUT @File;Pathval(*)
910 ASSIGN @File TO *
920 END
930 SUB Read_bitmap(S$)
940     COM @Sw,@File
950     DIM Response(31),Bitmap(7,31)
960     FOR I=0 TO 7
970         OUTPUT @Sw;S$&"? (@"&VAL$(I+1)&"00:"&VAL$(I+1)&"31);"
980         ENTER @Sw;Response(*)
990         MAT Bitmap(I,*)= Response
1000    NEXT I
1010    OUTPUT @File;Bitmap(*)
1020 SUBEND

```

Restore Memory

The following program can be used to restore the EEROM state read out by READMEM:

```
10      ! WRITEMEM program. Takes a file written by READMEM and
        sends it to the HP 87130A.
20      DIM A$(32767)
30      DIM Respond(31),Sense(7,31),Unused(7,31),Pfac(7,31),
        Pfao(7,31),Widt(7,31),Delay(7,31)
40      DIM Serialnumber$(10),Modelnumber$(6)
50      DIM Gpnames$(15)[12],Gptitles$(15)[32]
60      DIM Pathnames$(255)[12],Pathtitles$(255)[32],
        Pathval(255)
70      DIM Groupdata$(15,255)[12],Groupauto(15)
80      COM @File,@Sw
90      MAT Pathnames$= ("")
100     MAT Gpnames$= ("")      ! Group names
110     MAT Pathtitles$= ("")
120     MAT Gptitles$= ("")    ! Group titles
130     MAT Groupdata$= ("")
140     ASSIGN @File TO "SWDATA"
150     ASSIGN @Sw TO 709
160     OUTPUT @Sw;"MEM:DELETE;"
170     OUTPUT @Sw;"ROUT:VERIFY:OFF:ALL;"
180     Getandsend_bmap("ROUT:VERIFY:ON")
190     OUTPUT @Sw;"ROUT:DRIVE:OFF:ALL;"
200     Getandsend_bmap("ROUT:DRIVE:ON")
210     Getandsend_bmap("ROUT:PFA:CLOS")
220     Getandsend_bmap("ROUT:PFA:OPEN")
230     ENTER @File;Serialnumber$
240     OUTPUT @Sw;"DIAG:SER ""&Serialnumber$&""";"
250     ENTER @File;Modelnumber$
260     OUTPUT @Sw;"DIAG:MOD ""&Modelnumber$&""";"
270     Getandcalc_bmap("ROUT:WIDT")
280     Getandcalc_bmap("ROUT:DELAY")
290     ENTER @File;Gpnames$(*)
300     ENTER @File;Groupdata$(*)
310     ENTER @File;Groupauto(*)
320     ENTER @File;Gptitles$(*)
```



```

330  ENTER @File;Pathnames$(*)
340  FOR I=0 TO 255  !  send path data
350      IF Pathnames$(I)<>" " THEN
360          ENTER @File;A$
370  OUTPUT@Sw;"ROUT:PATH:DEF"&Pathnames$(I)&" , "&A$&" ;"
380      END IF
390  NEXT I
400  FOR I=0 TO 15    !  send group data
410      IF Gpnames$(I)<>" " THEN
420          OUTPUT
            @Sw;"ROUT:GROUP:NAME"&VAL$(I+1)&" , "&Gpnames$(I)&" ;"
430          IF Groupauto(I) THEN
440              OUTPUT @Sw;"ROUT:GROUP:AUTOSELECT:ON
                "&Gpnames$(I)&" ;"
450          ELSE
460              OUTPUT @Sw;"ROUT:GROUP:AUTOSELECT:OFF"
                &Gpnames$(I)&" ;"
470          END IF
480          IF Gptitles$(I)<>" " THEN OUTPUT
            @Sw;"ROUT:GROUP:LABEL" "&Gpnames$(I)&" ,
            ""&Gptitles$(I)&" "" ;"
490          J=0
500          WHILE Groupdata$(I,J)<>" "
510              OUTPUT @Sw;"ROUT:GROUP:ADD
                "&Gpnames$(I)&" , "&" "&Groupdata$(I,J)&" ""&" ;"
520              J=J+1
530          END WHILE
540      END IF
550  NEXT I590      IF Pathnames$(I)<>" " THEN
560  ENTER @File;Pathtitles$(*)
570  ENTER @File;Pathval(*)
580  FOR I = 0 to 255
590      IF Pathnames$(I)<>" " THEN I=0 TO 255
600          OUTPUT @Sw;"ROUT:PATH:LAB "&Pathnames$(I)&" ,
            ""&Pathtitles$(I)&" "" ;"
610          OUTPUT @Sw;"ROUT:PATH:VAL"&Pathnames$(I)&" ,
            "&VAL$(Pathval(I))&" ;"
620      END IF
630  NEXT I
640  ASSIGN @File TO *

```

Remote Operation

Example Programs

```
650 END
660 SUB Getandsend_bmap(B$)
670 ! Loads a query response from file and outputs it as a
    channel list
680 COM @File,@Sw
690 DIM Bitmap(7,31),A$[32767]
700 ENTER @File;Bitmap(*)
710 FOR I=0 TO 7
720     A$=""
730     FOR J=0 TO 31
740         IF Bitmap(I,J) THEN A$=A$&" "&VAL$(100*(I+1)+J)
750     NEXT J
760     IF A$[1;1]="," THEN A$=A$[2]
770     IF A$<>" " THEN OUTPUT @Sw;B$&" ("&A$&");"
780 NEXT I
790 SUBEND
800 SUB Getandcalc_bmap(B$)
810 ! Loads a query response from a file and outputs it to
    set drive/delay time
820 COM @File,@Sw
830 DIM Bitmap(7,31),A$[32767]
840 ENTER @File;Bitmap(*)
850 FOR I=0 TO 7
860     FOR J=0 TO 31
870         OUTPUT @Sw;B$&" "&VAL$(Bitmap(I,J)&" ,
            ("&VAL$(100*(I+1)+J)&");"
880         IF Bitmap(I,J) THEN A$=A$&" "&VAL$(100*(I+1)+J)
890     NEXT J
900     IF A$[1;1]="," THEN A$=A$[2]
910 NEXT I
920 SUBEND
```

Example Speed Calculation

Switching speed is a function of pulse widths, sensing delays, the state of the chosen channels, and the sequence of relays driven. A sample program and timing diagram are provided to help the user minimize switching time, since the user determines pulse widths, sensing delays and which channels are opened or closed.

The HP 87130A power supply limits the switch driver to a total of 800 mA to drive relays at any one time. This means that four throws of 200 mA each is the limit for one switching operation. If you want to increase the speed at which your switch matrix operates, you need to know which four relays, when connected, will be on the same drive lines.

Table 6-7 shows which connectors (J1 to J31) are on the same drive lines. Refer to the installation instructions (Figure 2-4) to wire your relay into the arbitrary positions of OPEN and CLOSE.

Table 6-7 *Relay Drive Sequence*

Drive Line	Connector Locator	Channel List
1	J1, J2, J3, J4	00, 01, 02, 03
2	J5, J6, J7, J8	04, 05, 06, 07
3	J9, J10, J11, J12	08, 09, 10, 11
4	J13, J14, J15, J16	12, 13, 14, 15
5	J17, J18, J19, J20	16, 17, 18, 19
6	J21, J22, J23, J24	20, 21, 22, 23
7	J25, J26, J27, J28	24, 25, 26, 27
8	J29, J30, J31	28, 29, 30

The following program along with Figure 6-1 can be used to learn how to determine switching speed. It is intended to show how the drive line architecture of the switch driver/driver board(s) and the programmed variables of :DELay and :WIDTh can be calculated for a total switching time for any switching operation.

Recall that the channel number is a three digit number where the first digit is the driver card number. Channel 130 is channel 30 on driver card 1. Channel 825 is channel 25 on driver card 8.

Remote Operation

Example Speed Calculation

```
10 DIM Closl$[40]
20 OUTPUT 709:"*RST"
30 OUTPUT 709;"ROUT:DRIV:ON (@100:111);"
40 !
50 !     Drive is set to ON for channels 100 through 111 using
60 !     a range.
70 OUTPUT 709;"ROUT:DRIV:OFF (@112:130);"
80 !
90 !     Drive is set to OFF for remaining channels on driver
100 !     card 1.Unless channels are part of Drive list, no
110 !     pulse (:WIDTh) is sent.
120 OUTPUT 709;"ROUT:VER:ON (@100:111);"
130 !
140 !     Sensing is ON for channels 100 through 111.
150 !     VERify:ON works at switching time, and errors
160 !     (if they exists) are reported back immediately.
170 !
180 !     Unless channels are part of Verify list no sensing
190 !     (:DELay) can be valid.  In other words,
190 !     you can choose to sacrifice sensing for speed.
200 !
210 !
220 OUTPUT 709;"ROUT:CLOS (@100:111);"
230 !
240 !     This command ensures all channels start in the same
250 !     (CLOSE) state.
260 OUTPUT 709;"ROUT:CLOS? (@100:111);"
270 !
280 !     Queries CLOSe list.
290 !
300 ENTER 709;Closl$
310 PRINT Closl$
320 !
330 !     Switch driver response should look like:
330 !     1,1,1,1,1,1,1,1,1,1,1,1
340 !     This indicates all 12 active channels are in the
350 !     CLOSE) state.
360 PAUSE
```

NOTE

For this example, all relays start at the same (CLOSE) state and have delays and pulse widths to make the calculation easier to follow. In real situations, relays may be in different states. You must programmatically keep track of these relays for your time calculations to be correct.

```

370 DIM Openl$[40]
380 OUTPUT 709;"ROUT:WIDT .04,(@100,102,104,108);"
390 !
400 !     Pulse (:WIDTh) is set to 40 ms for channels 100,102,
410 !     104, and 108. When :OPEN is sent, 100 and 102
420 !     will OPEN at the same time.
430 !     Channels 104 and 108 will each OPEN at different
440 !     times, because they are connected to different
450 !     drive lines. See the Relay Drive Sequence table
460 !     and Figure 6-1, Timing Diagram.
470 !     In the absence of a pulse width declaration for
480 !     channels 101 and 103, of 30 ms seconds is applied.
490 OUTPUT 709;"ROUT:DEL .015,(@100:103);"
500 !
510 !     Sensing (:DELay) is set to 15 ms for channels 100
520 !     to 103.
530 OUTPUT 709;"ROUT:VER:OFF (@104:107);"
540 !
550 !     Example of sensing sacrificed for speed.
560 !     :DELay is invalid for channels 104, 105, 106, 107.
570 !
580 OUTPUT 709;"ROUT:WIDT 0.05,(@109:111);"
590 !
600 !     Channels 109, 110, 111 set to 50 ms pulse (WIDTh).
610 !
620 OUTPUT 709;"ROUT:DEL 0.025,(@109:111);"
630 !
640 !     Sensing delays for 109, 110, 111 set to 25 ms.
650 !
660 OUTPUT 709;"ROUT:OPEN (@100:111);"
670 !
680 !     See timing chart to predict when each relay will
690 !     open.
700 OUTPUT 709;"ROUT:OPEN? (@100:104,108:111);"
710 !

```

Remote Operation
Example Speed Calculation

```

720 !      You turned sensing off for 104 thru 107, remember?
730 !      About OPEN?: you could still query for the entire
740 !      open list for channels 100 to 111. Channels 104 to
750 !      107 would still report back 1,1,1,1.
750 !      The query :OPEN? (or :CLOSE?) queries the channel
760 !      list, not the relay. The switch
770 !      driver reports the state the switch should be in.
780 !
790 ENTER 709;Openl$
800 PRINT Openl$
810 !
820 !      Switch driver should respond with: 1,1,1,1,1,1,1,1,1
830 !
840 END

```

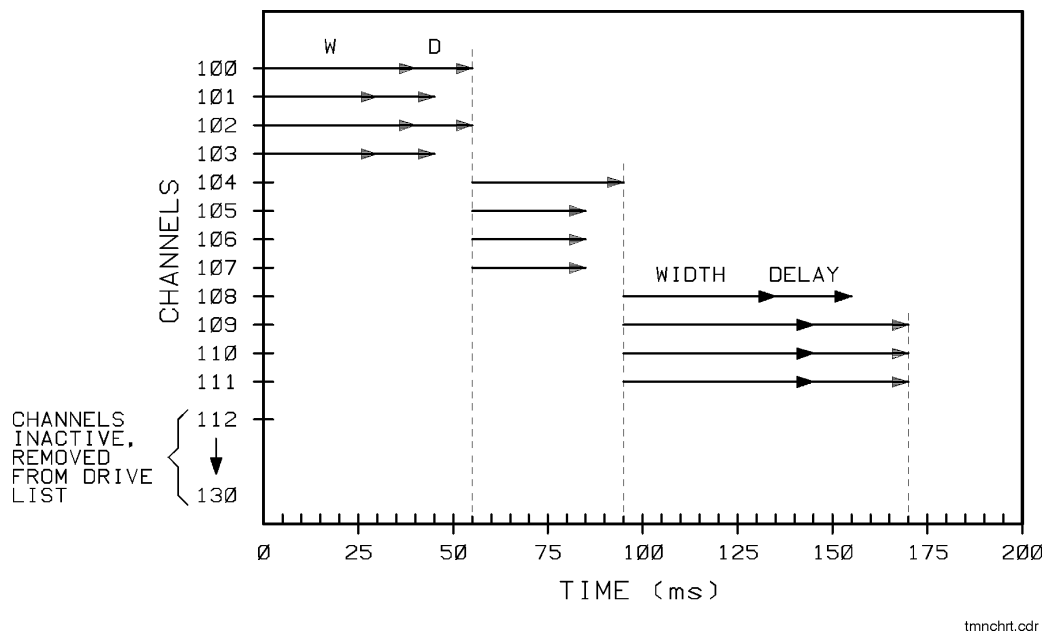

Figure 6-1 Timing Chart

7

Replaceable Parts

Overview

In this chapter you will find:

- Accessories available for the switch driver by part number and description.
- All replaceable parts referenced in chassis and cable assemblies.

Replaceable Parts

Accessory Boards and Cables

Additional driver boards, interconnect boards, and cables provide expanded capacity, remote switching and everything needed for device connection.

Table 7-1 *Accessories*

HP Part Number	Description
70611-60004	Cable, 68-pin to 68-pin SCSI II, 6 feet, 28 AWG
70611-60008	32 cables with connectors, 52 inches, 26 AWG (HP 84940A to switches)
70611-60010	Cable, 36-pin SCSI II to 36 pin SCSI II, shielded, 5 feet, 28 AWG
70611-60011	Cable, ribbon, 36-pin SCSI II to 34-pin, 18 inches, 28 AWG
70611-60013	Cable kit, ribbon 36-pin SCSI to 34-pin
70611-60014	Service Aid. (For use in performance tests)
70612-60011	Cable, dual 36-pin SCSI II to 34-pin ribbon, 36 inches, 28 AWG
HP 84940A	Driver board
HP 84941A	Distribution board

Firmware Revisions

Older versions of this instrument may have firmware part numbers different from those listed in Table , “Replaceable Parts”, for U7 and U8. However, the firmware parts listed are the most current versions of the firmware and are the preferred replacement parts. The current firmware versions are backward compatible for all instruments.

Table 7-2 Replaceable Parts - HP 87130A Chassis Assembly (1)

Part Location	HP Part Number	Quantity	Description	Reference Designator
1	87130-00009	1	Deck	—
2	87130-00011	1	Power supply shield	—
3	70611-60002	1	Driver board	A2
4	87130-00010	1	PC board bracket assembly	—
5	87130-00008	1	Shield, bottom cover	—
6	87130-60002	1	Controller board	A1
7	87130-00007	1	Shield, top cover	—
8	87130-00002	1	Front sub-panel	—
9	87130-00001	1	Front dress panel	—
10	87130-00004	1	Rear panel	—
11	0515-0458	11	Screw torx metric	—
12	0380-3095	4	Spacer, long	—
13	0380-3094	2	Spacer, short	—
14	0380-2088	2	Spacer	—
15	0515-1851	6	Screw, torx	—
16	0403-0423	6	Bumper foot, 12.5 OD	—
17	0535-0088	7	Nut, plastic locking	—
18	2360-0117	2	Screw, posidrive 6-32 x 0.375 pan head	—
19	7120-4294	2	Label, high voltage	—

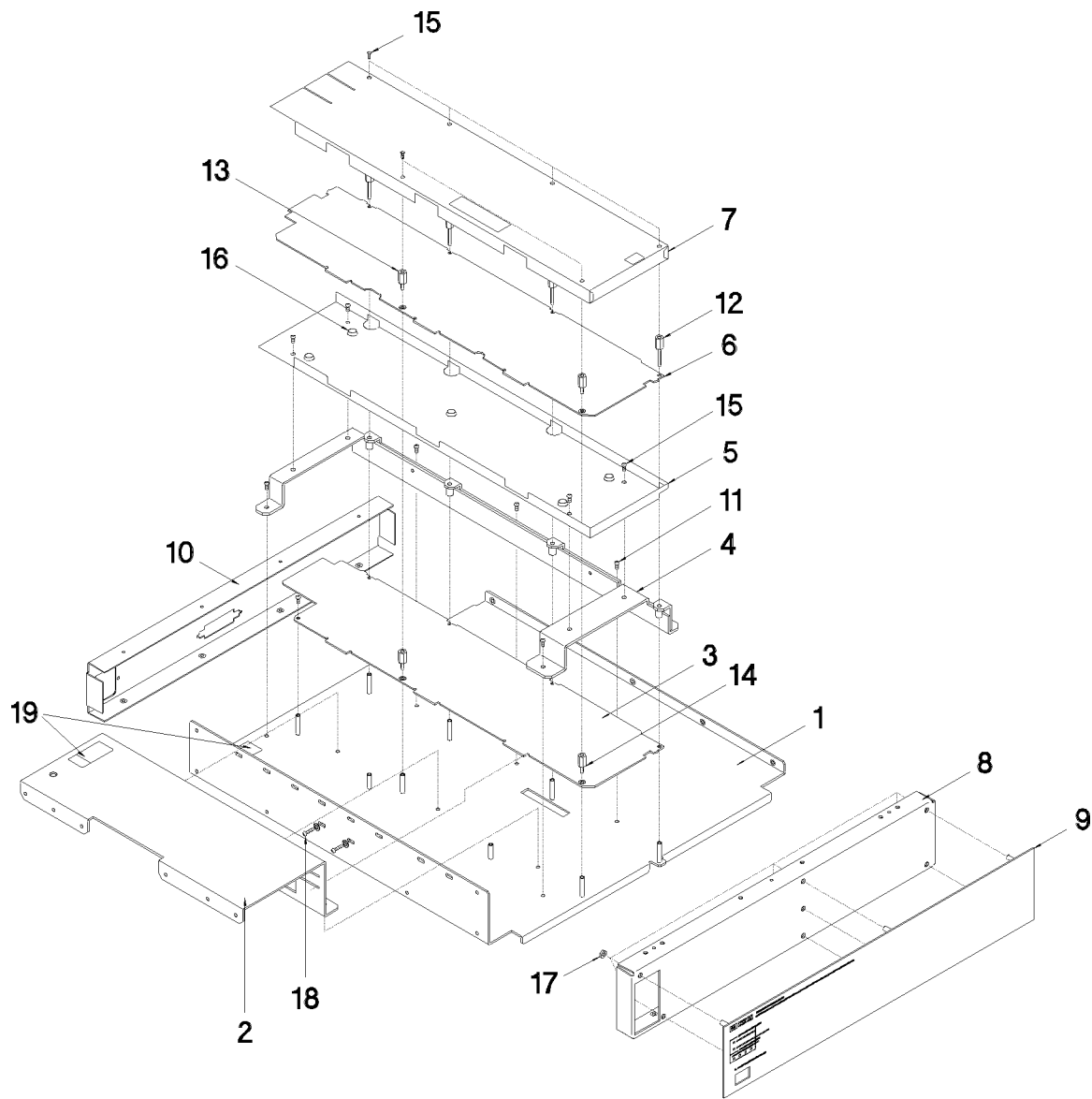

chassis1.cdr

Figure 7-1 HP 87130A Chassis Assembly (1)

Table 7-3 Replaceable Parts - HP Chassis Assembly (2)

Part Location	HP Part Number	Quantity	Description
1	5021-8401	1	Front frame
2	5021-5802	1	Rear frame
3	5021-5887	2	Side strut
4	5041-8802	1	Top trim
5	5062-3988	1	Front handle kit
6	5021-8495	2	Trim, front handle
7	5041-8801	4	Foot, bottom
8	5062-3776	2	Side cover
9	5062-3704	2	Strap handle
10	5041-8819	2	Front cap
11	5041-8820	2	Rear cap
12	5041-8821	4	Rear panel foot
13	5062-3747	1	Bottom cover
14	5062-3735	1	Top cover
15	0515-2036	8	Screw, FH M4 x 0.7 x 10L
16	0515-2039	6	Screw, torx T10 M 3.5 x 0.5x 8L
17	0515-0431	21	Torx pan M3.5 x 0.6 x 6L
18	0515-0458	11	Torx pan M3.5 x 0.6 x 8L
19	2360-0117	2	Screw, posidrive 6-32 x 0.375 pan head
20	0515-1384	4	Torx pan M 5 x0.8 x 10L
21	0515-2044	4	FH 4 x 0.7 x 10L
22	0515-1860	4	Torx pan M3.5 x 0.6 x 10L

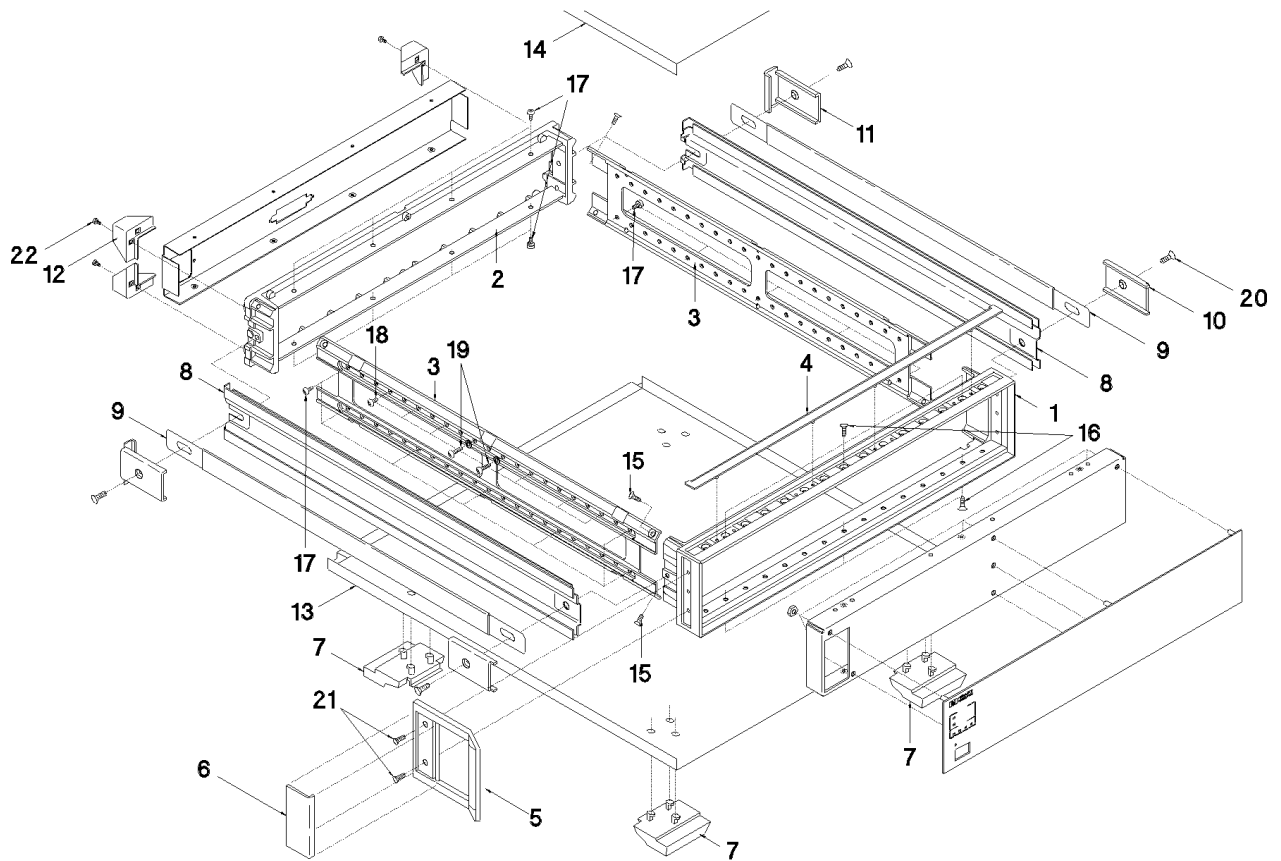

chassis2.cdr

Figure 7-2 HP 87130A Chassis Assembly (2)

Table 7-4 Replaceable Parts - HP 87130A Cable Assembly

Part Location	HP Part Number	Quantity	Description	Reference Designator
1	70611-60002	1	Driver board	A2
2	87130-60002	1	Controller board	A1
3	0950-2252	1	Power supply 110 W	A3
4	87130-60001	1	Display board	A4
5	87130-60008	1	HP-IB address board	A5
	3101-2325	1	HP-IB address switch (part of HP-IB address board)	—
6	87130-60007	1	AC line cable assembly	—
	2110-0782	1	Fuse T 1A 250V UL/CSA (part of AC input module)	—
	2110-0674 ¹	1	European fuse T 1A 250V IEC (part of AC input module)	—
7	87130-60006	1	34/36-pin SCSI cable	—
8	87130-60005	1	HP-IB address cable	W2
9	87130-60004	1	24-pin HP-IB cable	W1
10	87130-60003	1	Display cable	W3
11	3101-3008	1	Rocker switch	—
12	0515-1946	2	FH screw M 3.0 x 0.5 x 6 torx	—
13	1252-1900	2	Screw, jack 4-40	—
14	2260-0009		Nut, hex 4-40	—
15	0515-0430		Torx pan M 3.0 x 0.6 x 6	—
16	0515-2028	4	FH screw M 2.5	—
19	0515-0431	2	Torx pan M 3.5 x 0.6 x 6	—
U7	70611-80017	1	EPROM	—
U8	70611-80018	1	EPROM	—
20	2110-0001	1	Fuse 1A 250 V F	—
21	2110-0003	1	Fuse 3A 250V F	—
22	0515-1860	6	FH screw M 3.5 x 0.6 x 10 torx	—

¹ Required for 220V options

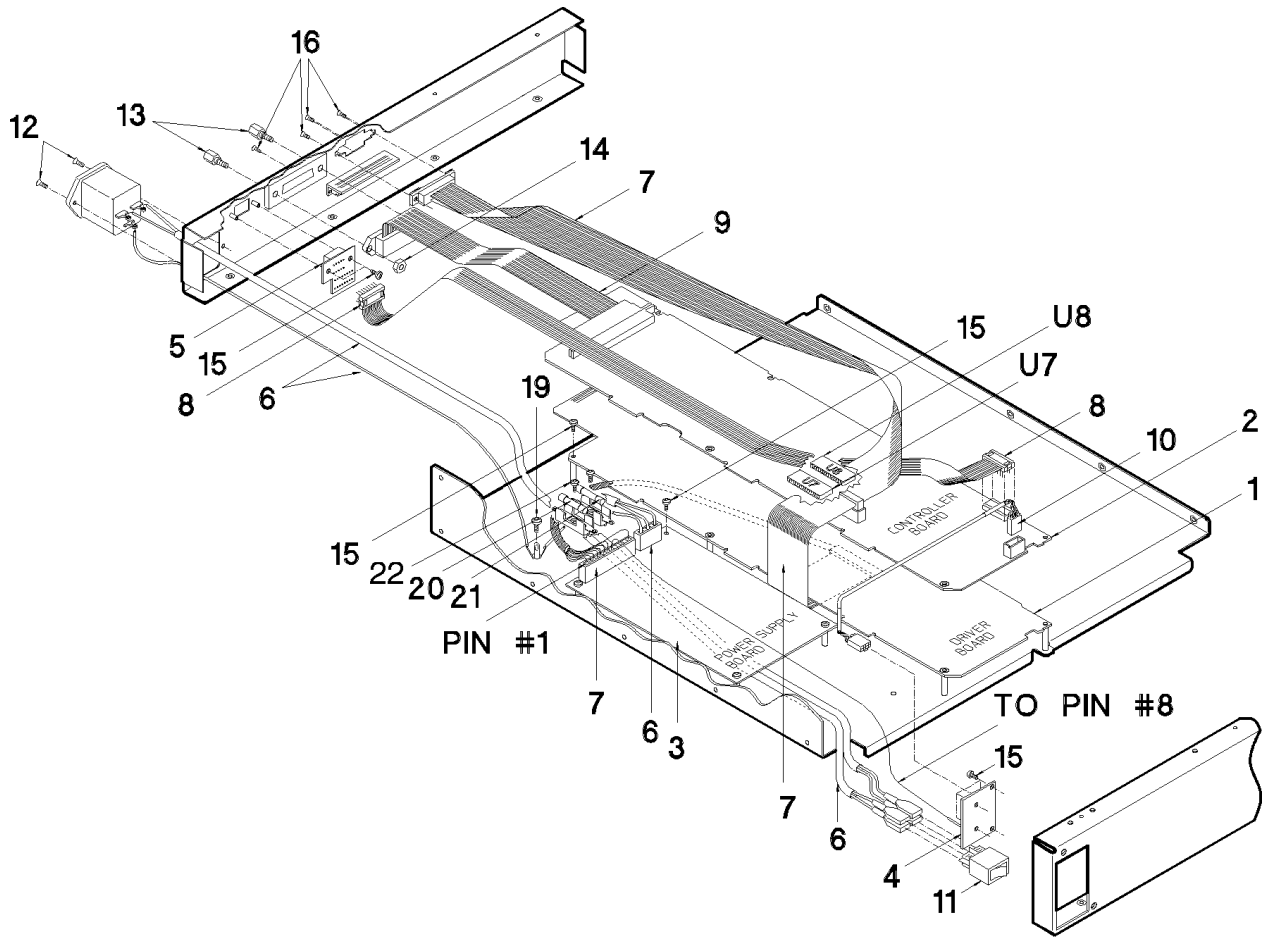

cblassy.cdr

Figure 7-3 HP 87130A Cable Assembly

Replaceable Parts

Overview

In this chapter you will find:

- Troubleshooting tests to isolate possible failures
 - Fuse test
 - Power supply test
 - Pulse parameter test
- Recommended test equipment
- Procedure for setting up the EPROM

Troubleshooting

Tests

To isolate the possible failure, the following tests may be performed. If your instrument is still in warranty or the switch driver does not meet the parameters of the following tests, we strongly recommend that you send the entire unit back to Hewlett-Packard for repair.

Fuse Test	Indicates fuse failure.
Power Supply Test	Indicates power supply failure.
Fuse Parameter Test	Indicates CPU failure or possible driver failure

WARNING

- **To avoid electrical shock, do not perform any servicing unless you are qualified to do so.**
- **Disconnect the product from all voltage sources while it is being opened. The opening of covers or removal of parts may expose dangerous voltages.**
- **The power cord is connected to internal capacitors that may remain live for five seconds after disconnecting the plug from its power supply.**

Conditions

If the performance tests are to be considered valid, the following conditions must be met:

- The HP 87130A must have one-half hour warm-up.
- The ambient temperature must be 0° to 55° C.
- The HP 87130A must pass all self tests.
- During any performance test, all shields and connecting hardware must be in place.
- Proper cables, adapters, and probes must be used for the test setups.
- The user must understand how to operate the specified test equipment needed for each test.

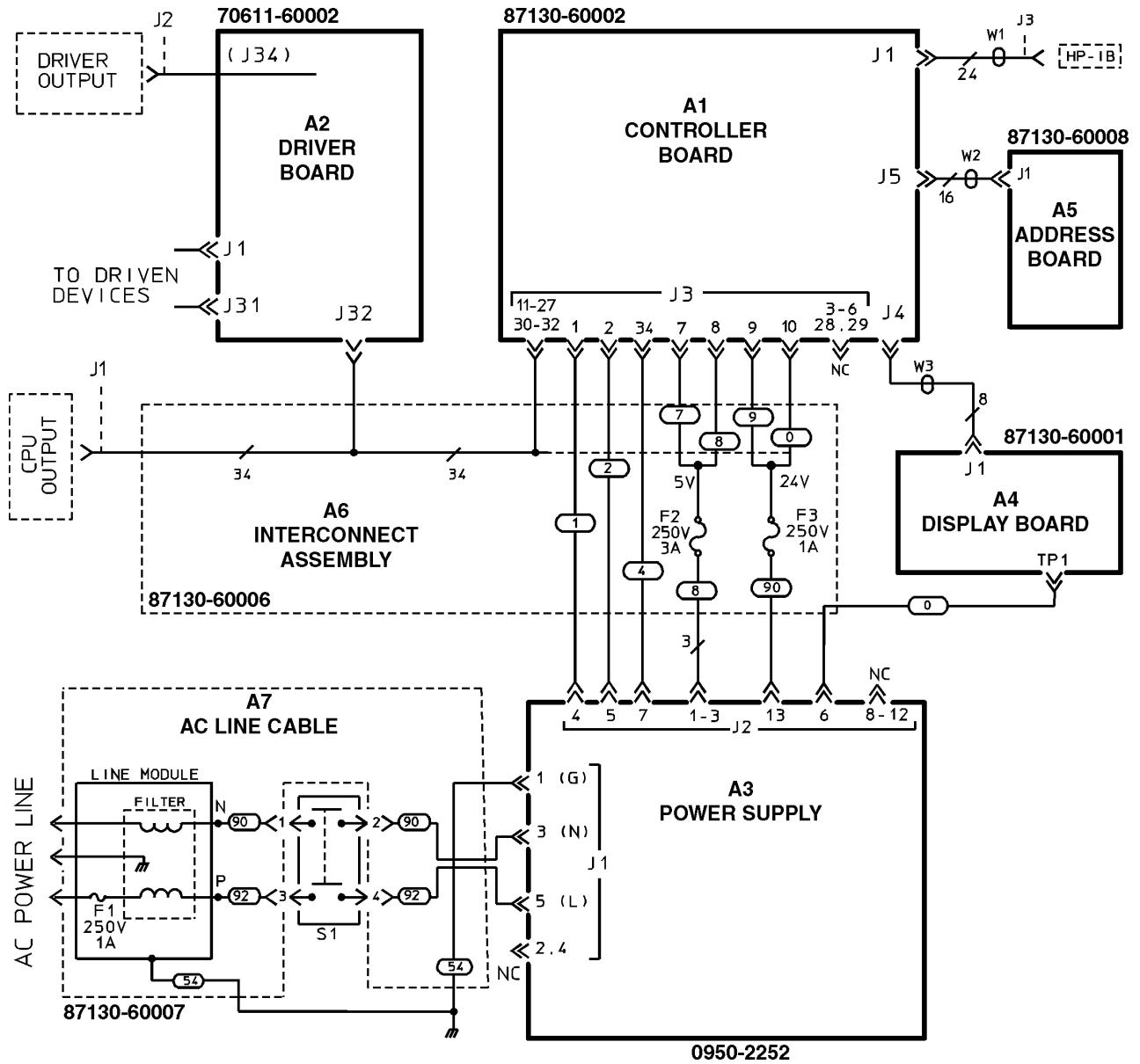

dcs.cdr

Figure 8-1 HP 87130A DC Schematic

Recommended Test Equipment

Recommended test equipment for the verification tests is given in the table below. Other equipment may be substituted if it meets or exceeds the critical specifications listed.

Table 8-1 Recommended Test Equipment for HP 87130A

Instrument	Critical Specifications	Recommended Model	Use ¹
External Driver	No substitute	HP 84940A	O, P, T
Controller	Must have HP-IB controller and software capability	UNIX workstation with RMB ² or PC with HP-IB and HP Basic for Windows capability	O, P, T
Oscilloscope	Bandwidth: dc - 100 MHz Vertical sensitivity: 5 V/div Vertical input: 50Ω impedance dc coupled Timebase: 5 ms/div	Various models	P, T
Test Accessory	No substitute	HP 70611-60014	P, T
Cable	No substitute	HP 70611-60010	P, T
Cable	No substitute	HP 70611-60004	P, T

¹P = Performance tests, T = Troubleshooting, O = Operator's checks

² Rocky Mountain Basic

To Install the Switch Driver

1. Set the switch driver power switch to OFF.
2. Ensure that the switch driver's HP-IB switch is set to 9. (Each instrument must have a unique HP-IB address.)
3. Set the switch driver power switch to ON.

Fuse and Power Supply Tests

Fuse Tests

If the HP 87130A fails to respond when the power switch is turned ON, the power line fuse should be checked. The 1 A, 250 V power line fuse (HP part number 2110-0782) is located inside the AC input module.

You will have to remove the top cover of the instrument to check the power supply fuses. The 1A, 250 V fuse (HP part number 2110-0001) with black and white wires attached to the fuse holder and 3A, 250V fuse (HP part number 2110-0003) with violet and gray wires attached to the fuse holder are located on the deck, next to the power supply board.

WARNING

For continued protection against fire hazard, replace the power line fuse with the same type and ratings only (1A/250V).

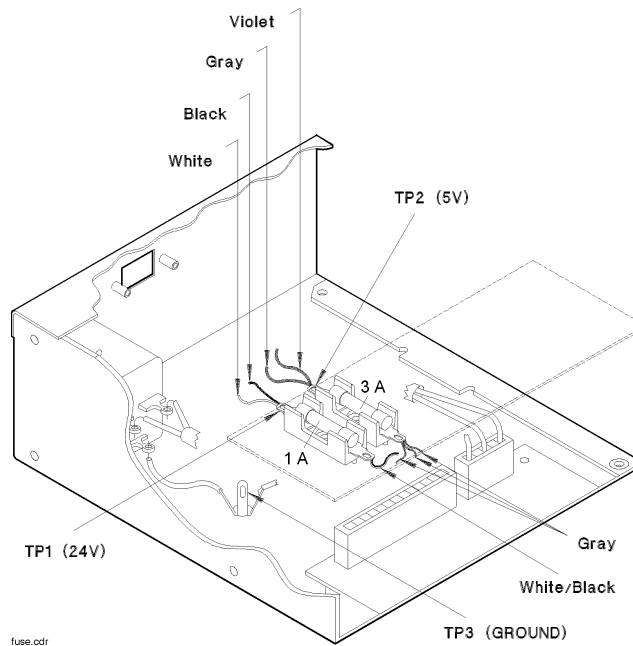

Figure 8-2 Power Supply Test Points

Power Supply Test

The power supply (HP part number 0950-2252) may be checked by measuring the voltages between TP3 (ground) and the following test points:

TP1	24 V +10% – 5%
TP2	5.1 V \pm 2%

Pulse Parameters Test

The pulse parameters test verifies the drive pulse parameters as delivered to the switches from the rear panel and from an external HP 84940A.

One channel (capable of driving four switches) is tested for switching speed at 30 ms (sensing disabled), voltage at +24 Vdc, and current at 200 mA for each switch (800 mA for all four switches.).

Table 8-2 Specification

Electrical Characteristics	Performance Limits	Conditions
Switching Speed:	0.050 ±0.005 s	(User set), Pulse width + delay
<i>Pulse width:</i>		
Maximum:	1.275 ±0.005 s	
Minimum:	0.005 ±0.005 s	
Default:	0.030 ±0.005 s	
<i>Sensing delay:</i>		
Maximum:	1.275 ±0.005 s	
Minimum:	0.005 ±0.005 s	
Default:	0.020 ±0.005 s	
Power:		
Voltage:	+24 ±3.0 Vdc	
Current:	800 mA maximum	200 mA per relay

Hardware Limits

The +24 volt supply in the switch driver can supply sufficient current to drive up to four HP 33311/8762 series relays at one time.

Each open collector driver IC can drive only one channel (a maximum of four switches) at a time to avoid exceeding package dissipation limits.

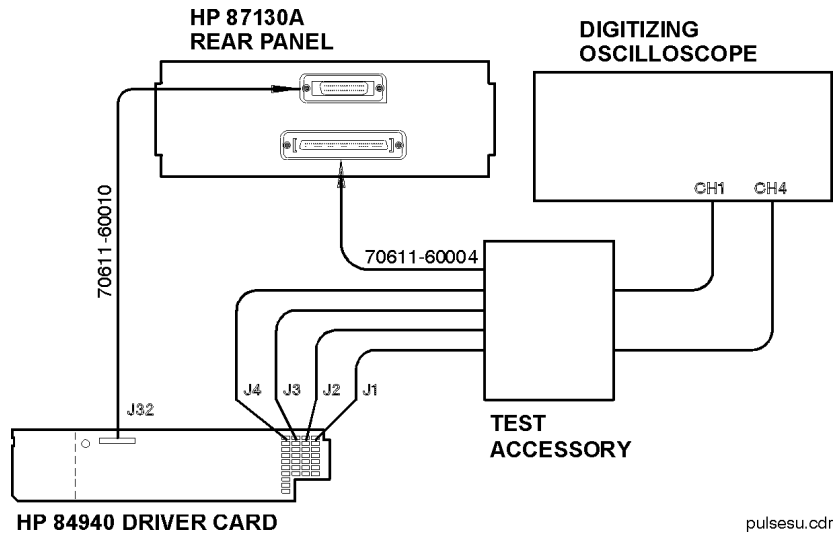

Figure 8-3 Pulse Parameters Test Setup

Equipment

Controller	Refer to Table 8-1.
Oscilloscope	Refer to Table 8-1.
Service Aid ¹	70611-60014
Driver Board	HP 84940A
Cable	70611-60004
Cable	70611-60010

¹This test accessory provides a 200 mA load for the driver.

Procedure

1. Set the switch driver power switch to OFF.

CAUTION

Do not connect or disconnect relays while the switch driver's LINE switch is ON, or an unintentional short to +24 V could occur. This will cause a catastrophic driver board failure.

2. Connect the equipment as shown in the test setup illustration for this procedure. (In this example, the HP-IB address is set to 9.)
 - If you are using an external driver, connect the test accessory to J1, J2, J3, J4. and connect cable (HP part number 70611-60010) from the CPU output of the HP 87130A to the HP 84940A driver card at J32.

Pulse Parameters Test

- If you are using an HP 87130A without an external driver, connect the test accessory with cable (HP part number 70611-60004) to the driver output of the HP 87130A.
3. Set the oscilloscope as follows:
 - Volts/div.....5V
 - Sweep speed 10 ms per div
 - Trigger..... INTERNAL
 4. Set the systems's LINE switch ON.

If you are using an HP 9000 Series 300 controller, you may use the following program:

```

10 OUTPUT 709;"*RST"
20 OUTPUT 709;"ROUT:DRIV:ON (@100:103);"
30 OUTPUT 709;"ROUT:DRIV:OFF (@104:130);"
40 !
50 ! OUTPUT 709;"ROUT:VER:ON (@100:103);"
60 !
70 ! For the Sensing (:VERify) Disabled test, comment out
80 ! line 50 and leave line 100 in the program, as shown
90 ! here.
100 OUTPUT 709;"ROUT:VER:OFF (@100:103);"
110 !
120 ! For the Sensing (:VERify) Enabled test, comment out
130 ! line 100 and leave line 50 in the program.
140 !
150 OUTPUT 709;"ROUT:WIDT .03,(@100:103);"
160 !
170 ! This sets the pulse (:WIDTh) to the default 30 ms.
180 !
190 OUTPUT 709;"ROUT:DEL .02,(@100:103);"
200 !
210 ! This sets the sensing (:DELay) to the default 20 ms.
220 ! When sensing (:VERify) is OFF (line 100), (:DEL) does
230 ! not apply.
240 ! Switching speed is then the 30 ms pulse (:WIDTh).
250 OUTPUT 709;"ROUT:CLOS (@100:103);"
260 PAUSE
270 OUTPUT 709;"ROUT:OPEN (@100:103);"
280 END

```

Voltage

1. Set the oscilloscope to 5 V/div.
2. Read the oscilloscope.
3. Record the reading. +21 V < _____ < 27 V

Current

Divide the voltage by **120Ω** to get the value of the current.

200 mA < _____

Switching Speed (sensing disabled)

1. Set the switch driver to 30 ms pulse width.
2. Set the oscilloscope to 5 ms/div.
3. Read the oscilloscope.
4. Record this reading. 25 ms < _____ < 35 ms

Switching Speed (sensing enabled)

1. Set the switch driver to 20 ms Delay.
2. Set the oscilloscope to 10 ms/div.
3. Read the oscilloscope.
4. Record this reading. 45 ms < _____ < 55 ms

HP 87130A Range	Minimum	Actual Results	Maximum
Voltage	21 Vdc		27 Vdc
Current	175 mA		225 mA
Switching Speed:			
Sensing Disabled	25 ms		35 ms
Sensing Enabled	45 ms		55 ms

Sensing Disabled

Each switch coil is internally connected between the +24 V bias supply and a power transistor. The transistor provides the ground return. A DC switch for the controller assembly provides the base current to actuate the transistor. This control current is nominally set to provide a pulse width of 20 ms. At the default setting, the switch driver provides a 30 ms pulse for actuating the electro-mechanical switch.

Sensing Enabled

The switch should be driven an additional 20 ms after the initial 30 ms closure pulse to allow sense lines to settle. At this time an error and a programmed position check are performed. The combined time for the switch driver to close a switch and verify its position is 50 ms.

Procedure for Setting Up the EPROM

Use the following procedure to set up the EPROM after the EPROM or the CPU board has been replaced.

- To set up the EPROM from the controller, use the following commands:

"MEM:DEL ;	Deletes everything in CMOS RAM memory.
"SYST:ERR? "	
READ HPIB FOR ERROR	Check error queue (this can be used at any point to read any error back).
"DIAG:MOD " "87130A" " , "	Writes model number of your instrument.
"DIAG:SER " "US37349017" " ; "	Writes unique serial number of your instrument (example is a typical serial number).
"ROUTE:DRIVE:ON(@X00:X30) "	Enables channels* to be engaged.
"ROUTE:VERIFY:ON(@X00:X30) "	Turns on sensing (can only be used with sensing switches. Do not turn on for non-sensing or non-HP switches.)
"MEM:SAVE ; "	Saves above configuration to EPROM.

- To power cycle the HP 87130A and check the EPROM:

"*IDN? "	
READ HPIB	Reads back the ID of the unit.

The screen should display:

"HEWLETT-PACKARD, 87130A, USXXXXXXXX, 950713"

"ROUTE:DRIVE:ON?(@X00,X01, X02,X03,X04,X05,X06,X07, X08,X09,X10,X11,X12,X13, X14,X15,X16,X17,X18,X19, X20,X21,X22,X23,X24,X25, X26,X27,X28,X29,X30) "	Queries X00 through X30
-------------------------------------------------------------------------------------------------------------------------------------------------------	-------------------------

READ HPIB	Reads back 1's and 0's for each channel. If VERIFY is ON, it will = 1; if OFF, it will = 0.
-----------	------------------------------------------------------------------------------------------------

* Each channel has its own unique address. The switch driver begins numbering channels at 0 instead of 1. Switch one, wired to J1 on driver card 1, would have a channel address of 100 and so forth up to card 800 to 830.

Index

A

- accessories, description, 7-3
- ADD, 6-27
- address
 - channel, 2-5
 - driver card, 2-11
 - factory preset, 2-4
 - HP-IB, 2-4
 - switch driver, 6-4
- AUTOselect, 6-28

B

- block diagram, 1-2
- boards, accessory, 7-3

C

- cable
 - I/O data, 2-13
 - output, 2-14
- cables, accessory, 7-3
- CATalog, 6-29
- CAUTION notice, vi
- channel
 - address, 2-5
 - creating lists, 6-26
 - definition, 2-5
 - list empty, 6-34
 - wiring connectors, 2-7
- character program data, 6-6
- characteristics, 3-2
- CLOSE, 6-30
- CLOSE condition defined, 2-7
- CLS, 6-13
- command syntax, 6-5
- common commands
 - *CLS, 6-13
 - *ESE, 6-14
 - *ESR?, 6-15
 - *IDN?, 6-16
 - *OPC, 6-17
 - *RST, 6-18
 - *SRE, 6-19
 - *STB?, 6-20
 - *TST?, 6-21
 - *WAI, 6-22
- compound command header, 6-5
- conditions for testing, 4-2, 8-2

- connecting
 - attenuators, 2-9
 - for speed, 2-10
 - multiple driver cards, 2-9
 - switch drivers, 2-5
- controllers, 6-2
- CYCLes, 6-33

D

- daisy chaining driver cards, 2-9
- DEFine, 6-34
- DELay, 6-36
- DELeTe, 6-37
- description, instrument, 1-2
- device selector, 6-3
- DIP switch, 2-11
- distribution board, 2-5
- DRIVE, 6-39
- driver board
 - external, 2-6
 - internal, 2-5
- driver cards, 2-6
- driver output connector, pin functions, 2-14

E

- EERom, 6-41
- electrical specifications, 3-2
- electrostatic discharge information, 1-7
- ENTER statement, 6-9, 6-11
- EPROM, setting up, 8-10
- ERRor?, 6-42
- ESD, 1-7
- ESE, 6-14
- ESR, 6-15

F

- FREE?, 6-45
- front panel features, 1-4
- fuse test, 8-5
- fuses, 2-2

G

- GROUP, 6-46

H

- hardware limits, 8-6
- header
 - compound, 6-5
 - options, 6-6
- HP-IB address, 2-4

I

- I/O data cable
 - description, 2-13
 - pin functions, 2-13
- IDN, 6-16
- initialization, 6-9
- INITialize, 6-47
- inspection, 2-2
- installation, 2-1
- instrument status, 6-11
- interface select code, 6-4

L

- LABel, 6-48

M

- MEMory, 6-49
- multiple driver cards, connecting, 2-9

N

- NAME, 6-50
- numeric program data, 6-7

O

- OPC, 6-17
- OPEN, 6-51
- OPEN condition defined, 2-7
- options, 1-4
- OUTPUT, 6-2
- output
 - buffer, 6-8
 - queue, 6-8, 6-9
- OUTPUT statement, 6-2, 6-3

P

- packaging material, 1-6
- parts identification, 7-1
- PATH, 6-54
- path name, 6-34
- performance tests, 4-2
- PFAil, 6-55

- pin functions
 - driver output connector, 2-14
 - I/O data cable, 2-13
- power
 - cord, 2-2
 - requirements, 2-2
- power supply test, 8-5
- program
 - header options, 6-6
 - message syntax, 6-4
 - message terminator, 6-7
- program data
 - character, 6-6
 - numeric, 6-7
- programming
 - language, 6-2
 - standard commands, 6-2
 - syntax, 6-3
- pulse parameters test, 4-3, 8-6

Q

- query command, 6-7

R

- receiving information from the switch driver, 6-9
- recommended test equipment, 4-2
- remote operation, 6-2
- REMOve, 6-56
- replaceable parts, 7-1
- replacing the EPROM, 8-10
- reset, 6-18
- returning for service, 1-9
- ROUTE, 6-57
- RST, 6-18

S

- safely information, vi
- SAVE, 6-58
- SCPI commands
 - ADD, 6-27
 - AUTOselect, 6-28
 - CATalog?, 6-29
 - CLOSE, 6-30
 - CYCLes?, 6-33
 - DEFine, 6-34
 - DELay, 6-36
 - DELete, 6-37
 - DRIVE, 6-39
 - EERom, 6-41
 - ERRor?, 6-42
 - FREE?, 6-45
 - GROUP, 6-46
 - INITialize, 6-47
 - LABel, 6-48

- MEMory, 6-49
- NAME, 6-50
- OPEN, 6-51
- PATH, 6-54
- PFAil, 6-55
- REMOve, 6-56
- ROUte, 6-57
- SAVE, 6-58
- STATus, 6-59
- SYSTem, 6-60
- TRIGger, 6-61
- VALue, 6-62
- VERify, 6-63
- VERsion, 6-65
- WIDTh, 6-66
- selecting multiple subsystems, 6-5
- sensing
 - delay, 1-2
 - disabled, 8-9
 - enabled, 8-9
- serial number, 6-47
- setting up the switch driver, 6-9
- specifications
 - electrical, 3-2
 - environmental, 3-3
- SRE, 6-19
- STATus, 6-59
- status registers, 6-11
- STB, 6-20
- string variables, 6-11
- supplemental characteristics, 3-2
- support information, iv
- switch driver
 - address, 6-4
 - initialization, 6-9
 - receiving information, 6-9
 - setup, 6-9
- syntax
 - command, 6-5
 - program message, 6-4
- SYSTem, 6-60

T

- talking to the switch driver, 6-3
- terminator
 - EOI, 6-7
 - NL, 6-7
 - program message, 6-7
- test equipment, recommended, 8-4
- test points, 8-5
- test query, 6-21
- tests
 - conditions for, 4-2, 8-2
 - performance, 8-2
- TRIGger, 6-61
- troubleshooting, 8-2
- typeface conventions, x

V

- VALue, 6-62
- VERify, 6-63
- VERsion, 6-65

W

- WAI, 6-22
- wait-to-continue, 6-22
- WARNING notice, vi
- WIDTh, 6-66
- wiring channel connectors, 2-7

